



City of Vancouver *Zoning and Development By-law*

*Planning and Development Services, 453 W. 12th Ave Vancouver, BC V5Y 1V4 tel 604.873.7344 fax 604.873.7060
planning@vancouver.ca*

CD-1 (571)

1300 - 1320 Richards Street

By-law No. 10995

(Being a By-law to Amend By-law 3575, being the Zoning and Development By-law)

Effective July 8, 2014

1 Zoning District Plan Amendment

This By-law amends the Zoning District Plan attached as Schedule D to By-law No. 3575, and amends or substitutes the boundaries and districts shown on it, according to the amendments, substitutions, explanatory legends, notations, and references shown on the plan marginally numbered Z-659 (b) attached as Schedule A to this By-law, and incorporates Schedule A into Schedule D, to By-law No. 3575.

2 Uses

- 2.1 The description of the area shown within the heavy black outline on Schedule A is CD-1 (571).
- 2.2 Subject to Council approval of the form of development, to all conditions, guidelines and policies adopted by Council, and to the conditions set out in this By-law or in a development permit, the only uses permitted and the only uses for which the Director of Planning or Development Permit Board will issue development permits are:
- (a) Dwelling Uses;
 - (b) Retail Uses, limited to Adult Retail Store, Grocery or Drug Store, Retail Store;
 - (c) Service Uses, limited to Barber Shop or Beauty Salon, Beauty and Wellness Centre, Laundromat or Dry Cleaning Establishment, Photofinishing or Photography Studio, Repair Shop - Class B, Restaurant - Class 1; and;
 - (d) Accessory Uses customarily ancillary to any uses permitted by this section.

3 Density

- 3.1 Computation of floor space ratio must assume that the site consists of 1,624.6 m², being the site size at the time of application for the rezoning evidenced by this By-law.
- 3.2 The floor space ratio for all uses must not exceed 12.32.
- 3.3 Floor area for retail and service uses must not exceed 575 m².
- 3.4 Computation of floor area must include all floors having a minimum ceiling height of 1.2 m, including earthen floor, both above and below ground level, measured to the extreme outer limits of the building.
- 3.5 Computation of floor area must exclude:
- (a) open residential balconies or sundecks and any other appurtenances which, in the opinion of the Director of Planning, are similar to the foregoing, except that:
 - (i) the total area of all such exclusions must not exceed 12% of residential floor area, and
 - (ii) the balconies must not be enclosed for the life of the building;
 - (b) patios and roof gardens, only if the Director of Planning first approves the design of sunroofs and walls;
 - (c) where floors are used for off-street parking and loading, the taking on or discharging of passengers, bicycle storage, heating and mechanical equipment, or uses, which in the opinion of the Director of Planning are similar to the foregoing, those floors or portions thereof so used, which are at or below base surface, except that the maximum exclusion for a parking space must not exceed 7.3 m in length; and
 - (d) all residential storage space above or below base surface, except that if the residential storage space above base surface exceeds 3.7 m² per dwelling unit, there will be no exclusion for any of the residential storage space above base surface for that unit.
- 3.6 Computation of floor area may exclude amenity areas, at the discretion of the Director of Planning or Development Permit Board, except that the exclusion must not exceed the lesser of 20% of the permitted floor area or 929 m².

3.7 The use of floor area excluded under sections 3.5 and 3.6 must not include any purpose other than that which justified the exclusion.

4 Building Height

4.1 The building height, measured from base surface, must not exceed 126.5 m, except that the building must not protrude into the approved view corridors, as set out in the City of Vancouver View Protection Guidelines.

5 Horizontal Angle of Daylight

5.1 Each habitable room must have at least one window on an exterior wall of a building.

5.2 The location of each such exterior window must allow a plane or planes extending from the window and formed by an angle of 50 degrees, or two angles with a sum of 70 degrees, to encounter no obstruction over a distance of 24.0 m.

5.3 Measurement of the plane or planes referred to in section 5.2 must be horizontally from the centre of the bottom of each window.

5.4 If:

- (a) the Director of Planning or Development Permit Board first considers all the applicable policies and guidelines adopted by Council; and
- (b) the minimum distance of the unobstructed view is not less than 3.7 m;

the Director of Planning or Development Permit Board may relax the horizontal angle of daylight requirement.

5.5 An obstruction referred to in section 5.2 means:

- (a) any part of the same building including permitted projections; or
- (b) the largest building permitted under the zoning on any site adjoining CD-1 (571).

5.6 A habitable room referred to in section 5.1 does not include:

- (a) a bathroom; or
- (b) a kitchen whose floor area is the lesser of:
 - (i) 10% or less of the total floor area of the dwelling unit, or
 - (ii) 9.3 m².

6 Acoustics

All development permit applications require evidence in the form of a report and recommendations prepared by a person trained in acoustics and current techniques of noise measurement, demonstrating that the noise levels in those portions of dwelling units listed below do not exceed the noise level set opposite such portions. For the purposes of this section, the noise level is the A-weighted 24-hour equivalent (Leq) sound level and is defined simply as noise level in decibels.

Portions of dwelling units	Noise levels (Decibels)
Bedrooms	35
Living, dining, recreation rooms	40
Kitchen, bathrooms, hallways	45

7 Severability

A decision by a court that any part of this By-law is illegal, void, or unenforceable severs that part from this By-law, and is not to affect the balance of this By-law.

8 Force and effect

This By-law is to come into force and take effect on the date of its enactment.

ENACTED by Council this 8th day of July, 2014.

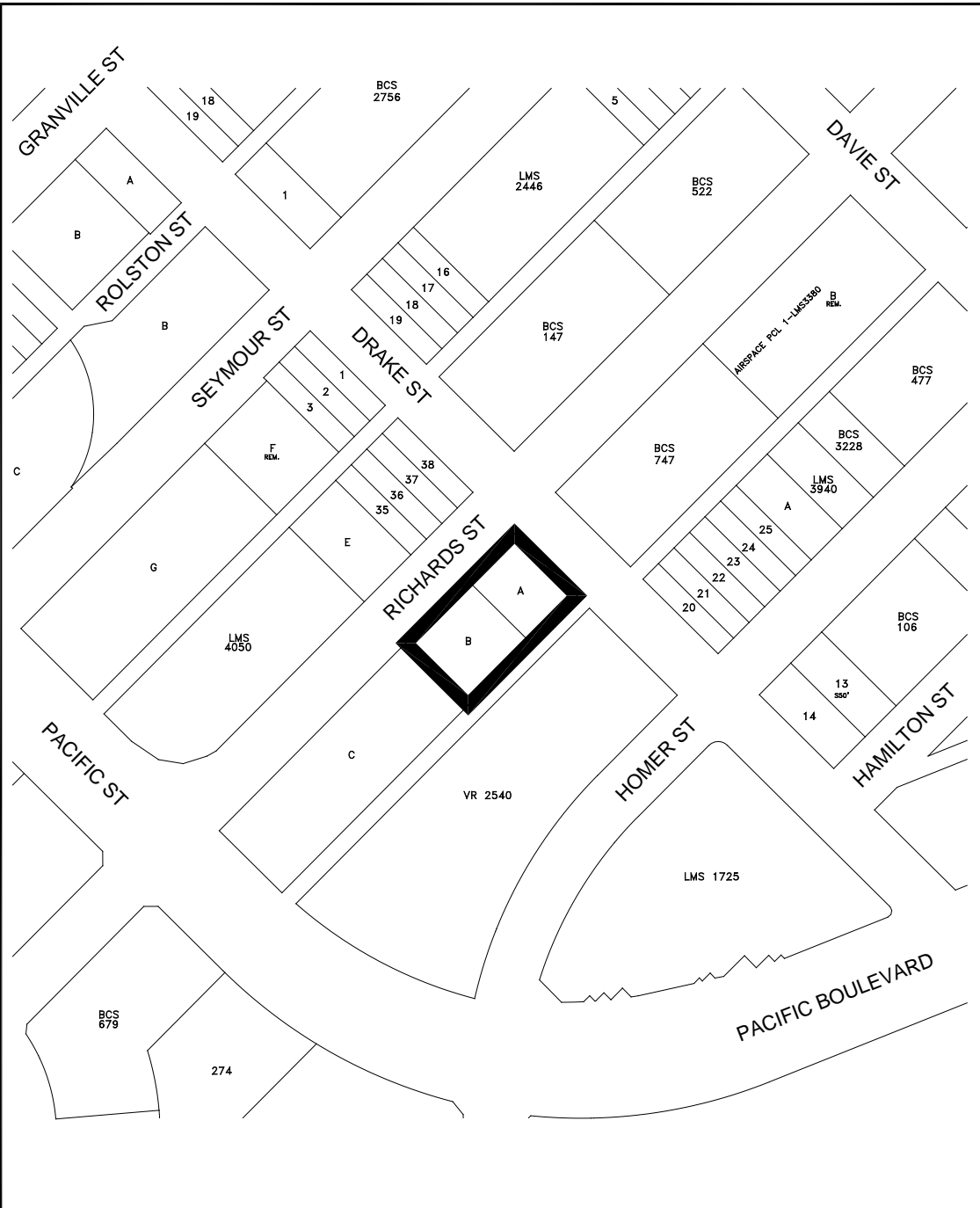

The properties outlined in black () are rezoned:
 From **DD** to **CD-1**

Z-659 (b)

RZ - 1300-1320 Richards Street	map: 1 of 1	
	scale: NTS	
City of Vancouver	date: 2013-03-13	