

City of Vancouver *Zoning and Development By-law*

Planning, Urban Design and Sustainability Department

453 West 12th Avenue, Vancouver, BC V5Y 1V4 | tel: 3-1-1, outside Vancouver 604.873.7000 | fax: 604.873.7100
website: vancouver.ca | email: planning@vancouver.ca

CD-1 (478)

188 East 1st Avenue

By-law No. 9850

(Being a By-law to Amend By-law 3575, being the Zoning and Development By-law)

Effective May 19, 2009

(Amended up to and including By-law No. 11630, dated September 21, 2016)

1 Zoning District Plan amendment

This By-law amends the Zoning District Plan attached as Schedule D to By-law No. 3575, and amends or substitutes the boundaries and districts shown on it, according to the amendments, substitutions, explanatory legends, notations, and references shown on the plan marginally numbered Z-602(e) attached as Schedule A to this By-law, and incorporates Schedule A into Schedule D to By-law No. 3575.

2 Definitions

In this By-law, despite section 2 of the Zoning and Development By-law, “base surface” means the base surface calculated from the official established building grades.

3 Uses

3.1 The description of the area shown within the heavy black outline on Schedule A is CD-1 (478).

3.2 Subject to Council approval of the form of development, to all conditions, guidelines and policies adopted by Council, and to the conditions set out in this By-law or in a development permit, the only uses permitted within CD-1 (478) and the only uses for which the Director of Planning or Development Permit Board will issue development permits are:

- (a) Cultural and Recreational Uses, limited to Artist Studio - Class A;
- (b) Dwelling Uses, limited to Multiple Dwelling and Seniors Supportive or Assisted Housing;
- (c) Institutional Uses, limited to Child Day Care Facility, Social Service Centre, and Community Care Facility;
- (d) Office Uses; [11630; 16 09 21]
- (e) Parking Uses;
- (f) Retail Uses, but not including Gasoline Station - Full Serve, Gasoline Station - Split Island, Liquor Store, and Vehicle Dealer;
- (g) Service Uses, limited to Barber Shop or Beauty Salon, Photofinishing or Photography Laboratory, Photofinishing or Photography Studio, Print Shop, Restaurant - Class 1, School - Arts or Self-Improvement, and School - Business;
- (h) Accessory Uses customarily ancillary to the uses listed in this section 3.2; and
- (i) Interim Uses not listed in this section 3.2, and accessory uses customarily ancillary to them, if:
 - (i) the Director of Planning or Development Permit Board considers that the interim use will be compatible with and not adversely affect adjacent development that either exists or that this By-law allows,
 - (ii) the Director of Planning or Development Permit Board is satisfied that the interim use is easily removable and is of low intensity or low in capital investment,
 - (iii) the Director of Planning or Development Permit Board is satisfied that there is no risk to the public from contaminated soils either on or adjacent to CD-1 (478), and
 - (iv) any development permit for an interim use has a time limit of three years.

4 Conditions of use

4.1 Dwelling units are in an “intermediate zone” as defined in the Noise Control By-law, and, as a result, are subject to the noise levels permitted in industrial and downtown districts.

4.2 All uses except dwelling uses must have direct access to grade.

5 Density

5.1 Computation of floor area must assume that the site consists of 1 123 m², being the site size at the time of the application for the rezoning evidenced by this By-law, and before any dedications.

Note: Information included in square brackets [] identifies the by-law numbers and dates for the amendments to By-law No. 9850 or provides an explanatory note.

- 5.2** The floor space ratio for all uses, combined, must not exceed 5.42.
- 5.3** Despite section 5.2, the Development Permit Board may permit an increase in floor space ratio, not to exceed 10%, resulting from a transfer of extra density from a designated heritage property, within the area of the Southeast False Creek Official Development Plan, in relation to which its receipt was as compensation for the reduction in market value at the time of designation.
- 5.4** Computation of floor area must include all floors having a minimum ceiling height of 1.2 m, including earthen floor, both above and below ground, measured to the extreme outer limits of the building.
- 5.5** Computation of floor area must exclude:
- (a) open residential balconies or sundecks, and any other appurtenances which, in the opinion of the Director of Planning, are similar to the foregoing, except that the total area of all exclusions must not exceed 8% of the residential floor area being provided;
 - (b) patios and roof gardens, if the Director of Planning first approves the design of sunroofs and walls;
 - (c) where floors are used for off-street parking and loading, the taking on or discharging of passengers, bicycle storage, heating and mechanical equipment, or uses which in the opinion of the Director of Planning are similar to the foregoing, those floors or portions thereof so used, which are at or below base surface, except that the maximum exclusion for a parking space must not exceed 7.3 m in length;
 - (d) undeveloped floor area located above the highest storey or half-storey with a ceiling height of less than 1.2 m, and to which there is no permanent means of access other than a hatch;
 - (e) all residential storage space above or below base surface, except that if the residential storage space above base surface exceeds 3.7 m² for a dwelling unit, there is to be no exclusion for any of the residential storage space above base surface for that unit;
 - (f) amenity areas including day care facilities, recreation facilities, and meeting rooms except that the total area excluded must not exceed 1 000 m²; and
 - (g) where a Building Envelope Professional as defined in the Building By-law has recommended exterior walls greater than 152 mm in thickness, the area of the walls exceeding 152 mm, but to a maximum exclusion of 152 mm thickness.
- 5.6** Computation of floor area may exclude, at the discretion of the Director of Planning or Development Permit Board:
- (a) enclosed residential balconies if the Director of Planning or Development Permit Board first considers all applicable policies and guidelines adopted by Council, and approves the design of any balcony enclosure, except that:
 - (i) the total area of all open and enclosed balcony or sundeck exclusions must not exceed 8% of the residential floor area being provided, and
 - (ii) enclosure of the excluded balcony floor area must not exceed 50%;
 - (b) windows recessed into the building face to a depth of no more than 160 mm, except that the Director of Planning or Development Permit Board may allow a greater depth in cases where it improves building character;
 - (c) unenclosed outdoor areas at grade level underneath building overhangs, if:
 - (i) the Director of Planning or Development Permit Board first considers all applicable policies and guidelines adopted by Council and approves the design of any overhangs, and
 - (ii) the area of all overhang exclusions does not exceed 1% of the residential floor area being provided;
 - (d) open to below spaces or double height volumes on the second storey units if the location of the first floor is within 2 m of grade to a maximum of 15% of the floor area of the first floor of that unit for residential units;

- (e) features which may be in the form of french balconies and horizontal extensions, on the westerly façades of buildings, to reduce solar gain; and
- (f) trellises and other garden structures which support the use of intensive green roofs and urban agriculture.

5.7 The use of floor space excluded under section 5.5 or 5.6 must not include any purpose other than that which justified the exclusion.

6 Building height

6.1 The building height, measured above base surface, and to the top of the roof slab above the uppermost habitable floor excluding parapet wall, must not exceed 38 m.

6.2 Despite section 6.1, maximum building height does not include mechanical penthouse, solar panels for energy collection, trellises, and similar structures which support the use of intensive green roofs and urban agriculture, as provided by section 10.11 of the Zoning and Development By-law.

7 Horizontal angle of daylight

7.1 Each habitable room must have at least one window on an exterior wall of a building.

7.2 The location of each such exterior window must allow a plane or planes extending from the window and formed by an angle of 50 degrees, or two angles with a sum of 70 degrees, to encounter no obstruction over a distance of 24.0 m.

7.3 If:

- (a) the Director of Planning or Development Permit Board first considers all the applicable policies and guidelines adopted by Council; and
- (b) the minimum distance of unobstructed view is not less than 3.7 m;

the Director of Planning or Development Permit Board may relax the horizontal angle of daylight requirement.

7.4 An obstruction referred to in section 7.2 means:

- (a) any part of the same building including permitted projections; or
- (b) the largest building permitted under the zoning on any site adjoining CD-1 (478).

7.5 A habitable room referred to in section 7.1 does not include:

- (a) a bathroom; or
- (b) a kitchen whose floor area is the lesser of:
 - (i) less than 10% of the total floor area of the dwelling unit, or
 - (ii) less than 9.3 m².

8 Parking, loading, and bicycle spaces

Any development or use of the site requires the provision and maintenance, in accordance with the requirements of, and relaxations, exemptions and mixed use reductions in, the Parking By-law, of off-street parking spaces, loading spaces, and bicycle spaces, all as defined under the Parking By-law, except that there must be at least one parking space for each 10 dwelling units.

9 Acoustics

All development permit applications require evidence in the form of a report and recommendations prepared by a person trained in acoustics and current techniques of noise measurement, demonstrating that the noise levels in those portions of dwelling units listed below do not exceed the noise level set opposite such portions. For the purposes of this section, the noise level is the A-weighted 24-hour equivalent (Leq) sound level and is defined simply as noise level in decibels.

Portions of dwelling units	Noise levels (Decibels)
bedrooms	35
living, dining, recreation rooms	40
kitchen, bathrooms, hallways	45

10 Severability

A decision by a court that any part of this By-law is illegal, void, or unenforceable severs that part from this By-law, and is not to affect the balance of this By-law.

11 Force and effect

This By-law is to come into force and take effect on the date of its enactment.

ENACTED by Council this 19th day of May, 2009.

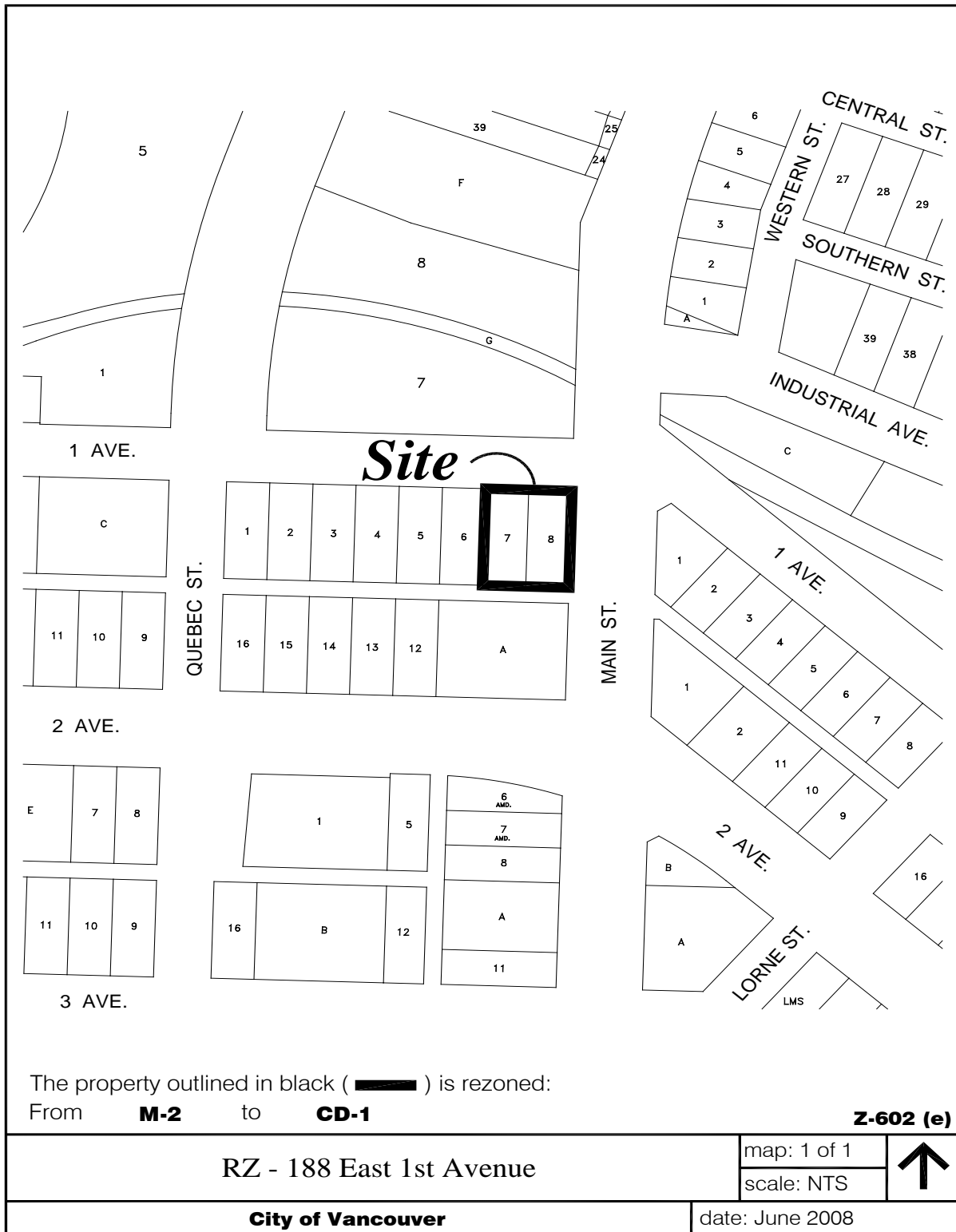

The property outlined in black (**█**) is rezoned:
 From **M-2** to **CD-1**

Z-602 (e)

RZ - 188 East 1st Avenue

map: 1 of 1

scale: NTS



City of Vancouver

date: June 2008