



City of Vancouver *Zoning and Development By-law*
Community Services, 453 W. 12th Ave Vancouver, BC V5Y 1V4 ☎ 604.873.7344 fax 873.7060
planning@city.vancouver.bc.ca

CD-1 (344)

325 West 59th Avenue

By-law No. 7522

(Being a By-law to Amend By-law 3575, being the Zoning and Development By-law)

Effective January 27, 1996

(Amended up to and including By-law No. 8865, dated June 8, 2004)

1 *[Section 1 is not reprinted here. It contains a standard clause amending Schedule D (Zoning District Plan) to reflect this rezoning to CD-1.]*

2 Uses

2.1 The description of the area shown within the heavy black outline on Schedule A is CD-1 (344).

2.2 The only uses permitted within CD-1 (344), subject to such conditions as Council may by resolution prescribe, and to the conditions set out in this By-law, and the only uses for which the Director of Planning or Development Permit Board will issue development permits are:

- (a) Dwelling Uses, limited to Multiple Dwellings containing a maximum of 43 dwelling units; and
- (b) Accessory Use customarily ancillary to any of the uses permitted by this section 2.2.

3 Density

3.1 The floor space ratio for all permitted uses must not exceed 1.0.

3.2 For the purpose of computing floor space ratio, the site consists of all parcels covered by this By-law, and Council deems the site size to be 5 700 m², being the site size at the time of the rezoning application and before dedication of any part of the site.

3.3 Computation of floor space ratio must include:

- (a) all floors having a minimum ceiling height of 1.2 m, including earthen floor, both above and below ground level, measured to the extreme outer limits of the building; and
- (b) stairways, fire escapes, elevator shafts, and other features the Director of Planning considers similar, to be measured by their gross cross-sectional areas and included in the measurements for each floor at which they are located.

3.4 Computation of floor space ratio must exclude:

- (a) open residential balconies or sun decks, covered patios and entries, and any other appurtenances which, in the opinion of the Director of Planning, are similar to the foregoing;
- (b) patios and roof gardens if the Director of Planning first approves the design of sunroofs and walls;
- (c) where floors are used for off-street parking and loading, the taking on or discharging of passengers, bicycle storage, heating and mechanical equipment, or uses which, in the opinion of the Director of Planning, are similar to the foregoing, those floors or portions thereof so used which are:
 - (i) at or below base surface, except that the exclusion for a parking space must not exceed 7.3 m in length, or
 - (ii) above base surface, and where developed as off-street parking are located in an accessory building situated in the rear yard, except that the exclusion for a parking space must not exceed 7.3 m in length;
- (d) amenity areas including day care facilities, recreation facilities, and meeting rooms to a maximum of 10% of the total permitted floor area;
- (e) areas of undeveloped floors located:
 - (i) above the highest storey or half-storey, and to which there is no permanent means of access other than a hatch, or
 - (ii) adjacent to a storey or half-storey with a ceiling height of less than 1.2 m;

Note: Information included in square brackets [] identifies the by-law numbers and dates for the amendments to By-law No. 7522 or provides an explanatory note.

- (f) all residential storage space above or below base surface, except that if the residential storage space above base surface exceeds 3.7 m² per dwelling unit, there will be no exclusion for any of the residential storage space above base surface for that unit; and
- (g) where a Building Envelope Professional as defined in the Building By-law has recommended exterior walls greater than 152 mm in thickness, the area of the walls exceeding 152 mm, but to a maximum exclusion of 152 mm thickness, except that this clause does not apply to walls in existence prior to March 14, 2000.

4 Building Height

The building height, measured above base surface, must not exceed 12.8 m.

5 Parking, Loading, and Bicycle Spaces

Any development or use of the site requires the provision and maintenance, in accordance with the requirements of, and relaxations, exemptions and mixed use reductions in, the Parking By-law, of off-street parking, loading, and bicycle storage, including a minimum of 1.1 parking spaces for each dwelling unit and one additional parking space for each 200 m² of gross floor area, except that a dwelling unit requires no more than two parking spaces.

6 Acoustics

All development permit applications require evidence in the form of a report and recommendations prepared by a person trained in acoustics and current techniques of noise measurement, demonstrating that the noise levels in those portions of the dwelling units listed below do not exceed the noise level set opposite such portions. For the purposes of this section, the noise level is the A-weighted 24-hour equivalent (Leq) sound level and is defined simply as noise level in decibels.

Portions of Dwelling Units	Noise Level (Decibels)
bedrooms	35
living, dining, recreation rooms	40
kitchen, bathrooms, hallways	45

7 Severability

A decision by a court that any part of this By-law is illegal, void, or unenforceable is not to affect the balance of the By-law.

[8865; 04 06 08]

- 8** *[Section 8 is not reprinted here. It contains a standard clause including the Mayor and City Clerk's signatures to pass the by-law and to certify the by-law number and date of enactment.]*

By-law No. 7522 being a By-law to amend By-law No. 3575

being the Zoning & Development By-law

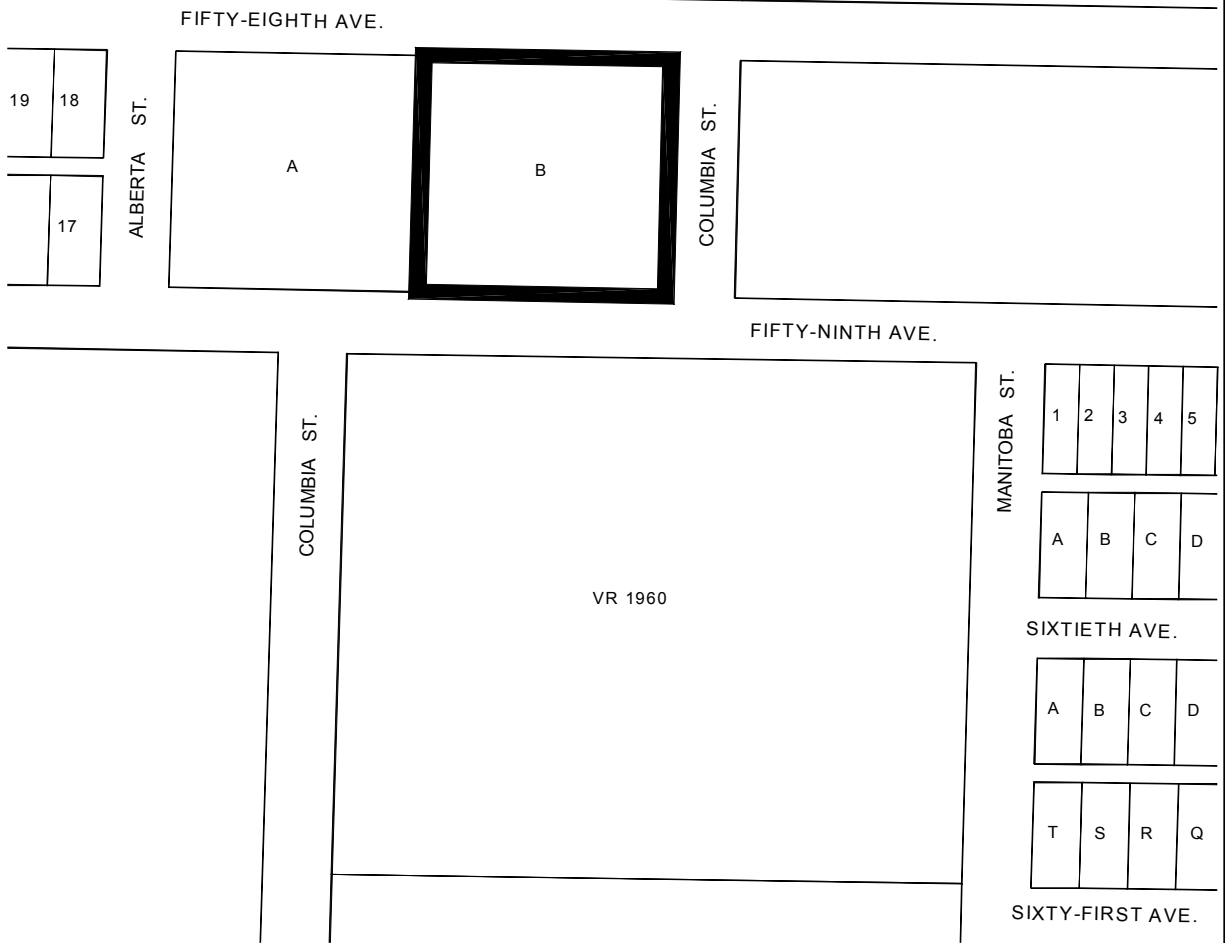

The property outlined in black () is rezoned:
From **RS-1** to **CD-1**

Z-438(b)

RZ - 325 W. 59th Avenue

map: 1 of 1

scale: 1:2000



City of Vancouver

[8865; 04 06 08]

