



City of Vancouver *Zoning and Development By-law*

*Planning and Development Services, 453 West 12th Avenue Vancouver, BC V5Y 1V4 tel 604.873.7000 fax 604.873.7100
planning@vancouver.ca*

CD-1 (303)

737 West 16th Avenue

By-law No. 7166

(Being a By-law to Amend By-law 3575, being the Zoning and Development By-law)

Effective September 2, 1993

(Amended up to and including By-law No. 11295, dated July 7, 2015)

1 *[Section 1 is not reprinted here. It contains a standard clause amending Schedule D (Zoning District Plan) to reflect this rezoning to CD-1.]*

2 Uses

The area shown included within the heavy black outline on Schedule “A” shall be more particularly described as CD-1(303), and the only uses permitted within the outlined area, subject to such conditions as Council may by resolution prescribe, and the only uses for which development permits will be issued are:

- (a) Dwelling Units;
- (b) Club;
- (c) Community Centre or Neighbourhood House;
- (d) Library;
- (e) Child Day Care Facility;
- (f) Parking Uses;
- (g) Any of the following uses, limited to a collective total of 780 m²:
 - Financial Institution
 - General Office
 - Health Care Office
 - Health Enhancement Centre
 - Retail Store
 - Restaurant - Class 1; [7310; 94 06 21]
- (h) Church, limited in size to 260 m²;
- (i) School - Elementary or Secondary, limited in size to 260 m²; and [11295; 15 07 07]
- (j) Accessory Uses customarily ancillary to the above uses.

3 Floor Space Ratio

3.1 The floor space ratio shall not exceed 2.50. For the purpose of computing floor space ratio, the site shall be all parcels covered by this By-law, and shall be deemed to be 3 375 m², being the site size at time of application for rezoning, prior to any dedications.

3.2 The following shall be included in the computation of floor space ratio:

- (a) all floors having a minimum ceiling height of 1.2 m, including earthen floor, both above and below ground level, to be measured to the extreme outer limits of the building; and
- (b) stairways, fire escapes, elevator shafts and other features which the Director of Planning considers similar, to be measured by their gross cross-sectional areas and included in the measurements for each floor at which they are located.

3.3 The following shall be excluded in the computation of floor space ratio:

- (a) open residential balconies or sundecks, and any other appurtenances which, in the opinion of the Director of Planning, are similar to the foregoing;
- (b) patios and roof gardens, provided that the Director of Planning first approves the design of sunroofs and walls;
- (c) where floors are used for off-street parking and loading, bicycle storage, heating and mechanical equipment, or uses which in the opinion of the Director of Planning are similar to the foregoing, those floors or portions thereof so used, which are at or below the base surface, provided that the maximum exclusion for a parking space shall not exceed 7.3 m in length;
- (d) amenity areas, including day care facilities, recreation facilities and meeting rooms, to a maximum total of 10 percent of the total building floor area;

Note: *Information included in square brackets [] identifies the by-law numbers and dates for the amendments to By-law No. 7166 or provides an explanatory note.*

- (e) areas of undeveloped floors located above the highest storey or half-storey, or adjacent to a storey or half-storey, with a ceiling height of less than 1.2 m, and to which there is no permanent means of access other than a hatch; and
- (f) all residential storage space above or below base surface, except that if the residential storage space above base surface exceeds 3.7 m² per dwelling unit, there will be no exclusion for any of the residential storage space above base surface for that unit; [8760; 03 12 09]
- (g) where exterior walls greater than 152 mm in thickness have been recommended by a Building Envelope Professional as defined in the Building By-law, the area of the walls exceeding 152 mm, but to a maximum exclusion of 152 mm thickness, except that this clause shall not apply to walls in existence prior to March 14, 2000. [8169; 00 03 14]

4 Height

The maximum building height, measured above the base surface, shall be 17.0 m. Section 10.11 of the Zoning and Development By-law (Relaxation of Limitations on Building Heights) shall not apply.

5 Parking

Off-street parking must be provided, developed and maintained in accordance with the applicable provisions of the Parking By-law, except that churches must provide a minimum of one space for every five seats, up to 500 seats plus a minimum of one space for every four seats over 500 seats. One seat is equal to 0.5 m per length of pew.

The Director of Planning, in consultation with the City Engineer, may relax this requirement, taking into account religious practices or laws, size of membership and whether the church is local or regional in nature, and the extent of activities that may occur on the premises.

6 Acoustics

All development permit applications shall require evidence in the form of a report and recommendations prepared by a person trained in acoustics and current techniques of noise measurement demonstrating that the noise levels in those portions of the dwelling units listed below shall not exceed the noise level set opposite such portions. For the purposes of this section the noise level is the A-weighted 24-hour equivalent (Leq) sound level and will be defined simply as noise level in decibels.

Portions of dwelling units	Noise levels (Decibels)
Bedrooms	35
Living, dining, recreation rooms	40
Kitchen, bathrooms, hallways	45

[7515; 96 01 11]

7 *[Section 7 is not reprinted here. It contains a standard clause including the Mayor and City Clerk's signatures to pass the by-law and to certify the by-law number and date of enactment.]*

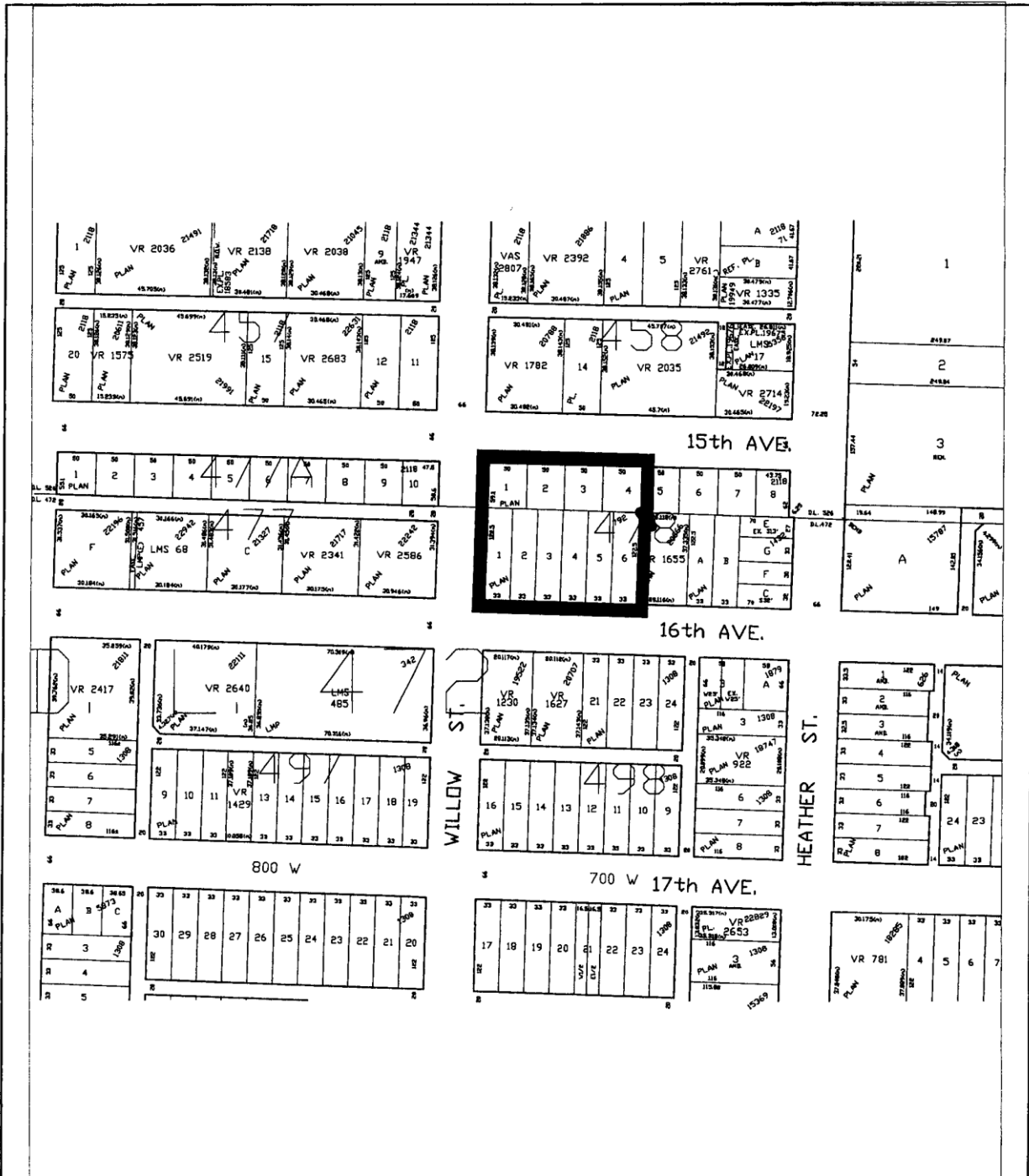

The property outlined in black (■) was rezoned:
 From **C-2** and **RM-4** to **CD-1** by By-law No. 7166

<p>CD-1 (303) 737 West 16th Ave.</p> <p>City of Vancouver Planning Department</p>	date prepared: Nov. 1994	
	sectional(s): N, O-14	
	scale: 1:2000	

