



City of Vancouver *Zoning and Development By-law*

Community Services, 453 W. 12th Ave Vancouver, BC V5Y 1V4 ☎ 604.873.7344 fax 873.7060
planning@city.vancouver.bc.ca

CD-1 (342)

1100-1114 Burnaby Street

By-law No. 7516

(Being a By-law to Amend By-law 3575, being the Zoning and Development By-law)

Effective January 16, 1996

(Amended up to and including By-law No. 8169, dated March 14, 2000)

1 *[Section 1 is not reprinted here. It contains a standard clause amending Schedule D (Zoning District Plan) to reflect this rezoning to CD-1.]*

2 Uses

The area shown included within the heavy black outline on Schedule “A” shall be more particularly described as CD-1(342) and the only uses permitted within the outlined area, subject to such conditions as Council may by resolution prescribe, and the only uses for which development permits will be issued are

- (a) Hotel, limited to an international hostel operated by a non-profit association, and
- (b) Accessory Uses customarily ancillary to the above use.

3 Floor Space Ratio

3.1 The floor space ratio must not exceed 1.80. For the purpose of computing floor space ratio, the site is all parcels covered by this By-law, and is deemed to be 1 606 m², being the site size at time of application for rezoning, prior to any dedications.

3.2 The following will be included in the computation of floor space ratio:

- (a) all floors, including earthen floor, to be measured to the extreme outer limits of the building;
- (b) stairways, fire escapes, elevator shafts and other features which the Director of Planning considers similar, to be measured by their gross cross-sectional areas and included in the measurements for each floor at which they are located.

3.3 The following will be excluded in the computation of floor space ratio:

- (a) patios and roof gardens, provided that the Director of Planning first approves the design of sunroofs and walls;
- (b) where floors are used for off-street parking and loading, bicycle storage, heating and mechanical equipment, or uses which, in the opinion of the Director of Planning, are similar to the foregoing, those floors or portions thereof so used, which are at or below the base surface, provided that the maximum exclusion for a parking space shall not exceed 7.3 m in length;
- (c) areas of undeveloped floors which are located
 - (i) above the highest storey or half-storey and to which there is no permanent means of access other than a hatch; or
 - (ii) adjacent to a storey or half-storey with a ceiling height of less than 1.2 m;
- (d) floors located at or below finished grade with a ceiling height of less than 1.2 m;
- (e) where exterior walls greater than 152 mm in thickness have been recommended by a Building Envelope Professional as defined in the Building By-law, the area of the walls exceeding 152 mm, but to a maximum exclusion of 152 mm thickness, except that this clause shall not apply to walls in existence prior to March 14, 2000. [8169; 00 03 14]

4 Height

The maximum building height measured above the base surface is 13.4 m.

Note: *Information included in square brackets [] identifies the by-law numbers and dates for the amendments to By-law No. 7516 or provides an explanatory note.*

5 Off-Street Parking

A minimum of 28 off-street parking spaces must be provided, developed and maintained in accordance with the applicable provisions of the Parking By-law, except that the minimum number of parking spaces can be reduced to 19 if arrangements are made to the satisfaction of the Director of Planning to provide a shuttle service between the site and another similar hostel facility or if 9 additional parking spaces are provided at an off-site location to the satisfaction of the Director of Planning.

6 *[Section 6 is not reprinted here. It contains a standard clause including the Mayor and City Clerk's signatures to pass the by-law and to certify the by-law number and date of enactment.]*

BY-LAW No. 7516 BEING A BY-LAW TO AMEND BY-LAW No. 3575
BEING THE ZONING & DEVELOPMENT BY-LAW

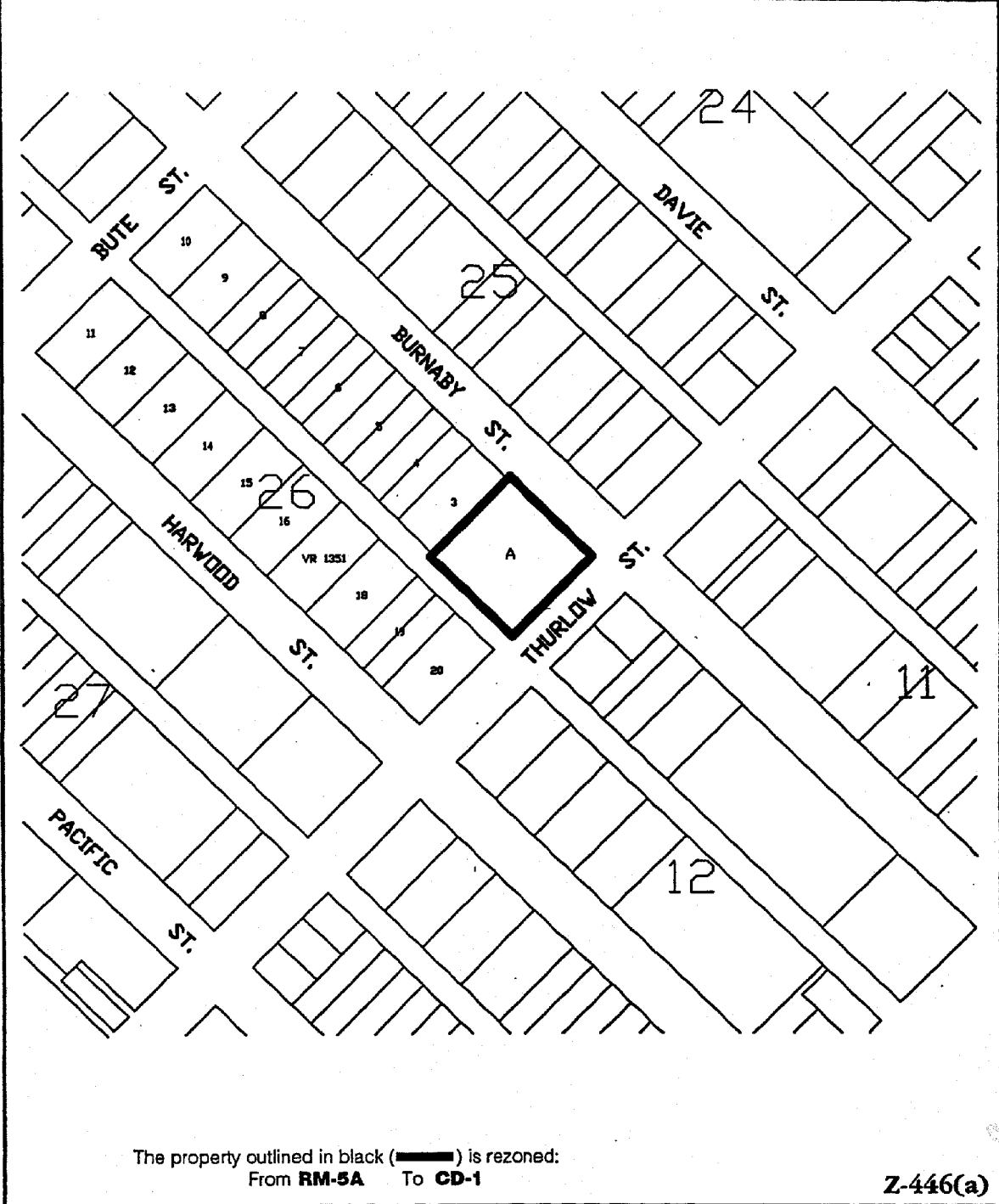

Z-446(a)

RZ 1100-1114 Burnaby Street	map: 1 of 1	
	scale: 1:2000	
City of Vancouver Planning Department		

CITY OF VANCOUVER
SPECIAL COUNCIL MEETING

A Special Meeting of the Council of the City of Vancouver was held on Tuesday, November 14, 1995, at 7:30 p.m., in the Council Chamber, Third Floor, City Hall, for the purpose of holding a Public Hearing to amend the Zoning and Development By-law.

PRESENT: Mayor Owen
Councillors Bellamy, Clarke, Hemer, Ip,
Kennedy, Kwan, Price, Pull and
Sullivan

ABSENT: Councillor Chiavario (Sick Leave)

CLERK TO THE COUNCIL: Gary MacIsaac

COMMITTEE OF THE WHOLE

MOVED by Cllr. Bellamy,
SECONDED by Cllr. Hemer,

THAT this Council resolve itself into Committee of the Whole, Mayor Owen in the Chair, to consider proposed amendments to the Zoning and Development By-law.

- CARRIED UNANIMOUSLY

1. Rezoning: 1100-1114 Burnaby Street

An application by Brook Development Planning Inc. was considered as follows:

The proposed rezoning from RM-5A Multiple Dwelling District, to CD-1 Comprehensive Development District, would:

- permit the re-use of two existing buildings, formerly used as a seniors' care facility, as a 225-bed international hostel;
- limit maximum building height to 13.4 m (44 ft.);
- limit maximum density to FSR 1.8;
- require the provision of 28 off-street parking spaces; and
- require amendment to the Sign By-law, and possible consequential amendments.

cont'd....

Clause No. 1 (cont'd)

The Director of Land Use and Development recommended approval, subject to the following conditions proposed for adoption by resolution of Council:

- (a) That the form of development be approved by Council as illustrated in plans prepared by Harry LeBlond, Architect and approved by the Director of Planning in Development Permit No. 30363 issued October 27, 1964 and as illustrated in plans prepared by Harry LeBlond, Architect and approved by the Director of Planning in Development Permit No. 94456 issued March 3, 1983, and any subsequent minor amendments approved prior to April 28, 1995, and provided that the Director of Planning may allow minor alterations to this form of development when approving the detailed scheme of development as outlined in (b) below.
- (b) That prior to approval by Council of the form of development, the applicant shall obtain approval of a development application by the Director of Planning, who shall have particular regard to the following:
 - (i) provision of adequate garbage and recycling facilities, to the satisfaction of the General Manager of Engineering Services;
 - (ii) provision of 19 parking spaces, to the satisfaction of the General Manager of Engineering Services;
 - (iii) arrangement for providing either an additional 9 parking spaces off-site or a shuttle service between the proposed hostel and the existing Jericho Hostel, to the satisfaction of the General Manager of Engineering Services; and
 - (iv) provision of bicycle storage spaces for 50 bicycles, to the satisfaction of the General Manager of Engineering Services.
- (c) That prior to enactment of the CD-1 By-law, and at no cost to the City, the registered owner shall:
 - (i) make suitable arrangements, to the satisfaction of the General Manager of Engineering Services, for undergrounding of all new electrical and telephone services within and adjacent the site from the closest existing suitable service point.

cont'd....

Clause No. 1 (cont'd)

Staff Opening Comments

Ms. Lynda Challis, Planner, advised this application proposes to take two buildings previously used as a seniors care facility, and re-use them as an international hostel. The two principal issues concerning this application are the proposed use and potential parking impacts.

In terms of the proposed use, an international hostel is considered in the Zoning & Development By-law as a hotel use, and the 1987 West End Residential Area Policy Plan does not support new hotels. However, staff support the proposed re-use on the basis that an international hostel is different from a hotel and this is a unique case and would not set a precedent for this area. The location and buildings are both well suited for an international hostel and the facility would contribute to the neighbourhood by maintaining the streetscape character and open space.

In terms of impact on traffic and parking, the applicant proposed 19 parking spaces which is the number currently on the site. A parking study was undertaken by the applicant and staff recommend an additional nine spaces be provided. The applicant has been offered the option of providing parking at the Jericho Hostel site, which is managed by the same organization, and running a shuttle bus between sites. Staff expect the traffic impacts to be minimal as the majority of guests at international hostels do not travel by car.

Applicant Opening Comments

Ms. Margot Paris, on behalf of Brook Development Planning Inc., advised this application is a good fit for hostelling, for the buildings and for the neighbourhood. This rezoning maintains for the future two modestly scaled buildings which are in excellent condition and belong in the fabric of this West End neighbourhood.

Under the current zoning, this building could open tomorrow as a rooming house in accordance with the outright use under the existing zoning. Under conditional zoning, it could operate as a hospice, hospital, group home or any other use that could be custodial in nature involving drug or alcohol treatment. Of these uses, hostelling will cause the least impacts on the neighbourhood.

Mr. John Hopkins, Executive Director, Hostelling International B.C., explained the structure and function of his organization, the reasons for acquiring a new facility and the manner in which the new hostel will complement the existing neighbourhood.

cont'd....

Clause No. 1 (cont'd)

Vancouver is one of the most popular destinations for hostellers in North America, and in the summer months, the Hostelling International facility at Jericho is in full capacity and turns away approximately 100 persons per day. The proposed facility will enrich the West End economically and culturally and will create jobs for residents. Hostels are more than just an inexpensive place to sleep, they are about creating community.

Responding to a question from a member of Council, Mr. Hopkins advised the new facility will be wheelchair accessible and International Hostelling B.C. will be giving consideration to making the Jericho facility wheelchair accessible, as it will be considering a number of renovations once this new hostel is on-stream.

Correspondence

A review of the correspondence received indicated the following:

- 15 letters in favour of the application;
- 55 form letters in favour of the application;
- 14 letters opposed to the application.

Speakers

The Mayor called for speakers and the following were in favour of the application:

- Sam Campbell
- Joan Enman
- Walter Kalyn
- Gloria Allison
- Derek Brown
- Brent Welty
- Erik Graff
- Barbara Thomas
- Sany Rahiman.

The foregoing supported the application for one or more of the following reasons:

- The application will provide more affordable low-cost housing;
- Hostels all over the world are located in residential neighbourhoods;

cont'd....

Clause No. 1 (cont'd)

- This is an excellent addition to the West End, and is preferable to another highrise which will increase the density;
- This application will preserve the existing buildings on site;
- This is a safe location for hostellers to visit;
- The International Hostelling Association is a well-managed and respected non-profit organization.

The following people opposed the application:

- Marie Hietakangas
- Jeff Nightingale.

The application was opposed on the basis that it contradicts the West End Residential Area Policy Plan which was adopted through a comprehensive public process in the late 1980s. At that time, there was division on many issues but, unanimity on the issue that no hotels be allowed in the residential area. The neighbourhood is opposed to hostels in the residential community and the criteria used to evaluate this application by the Planning Department could be indicative of any location in the West End. A 225-bed hostel will lead to thousands of people coming and going at this location on a monthly basis. These people will not have the same feel for the neighbourhood as the current residents.

Applicant Closing Comments

The applicant offered no additional comments.

Staff Closing Comments

Ms. Lynda Challis reiterated the differences between hostel use and hotel use that led staff to support this application. This is not seen to be precedent setting and does not represent a wholesale change or abandonment of the hotel policy which is reflected in the West End Residential Area Policy Plan.

MOVED by Cllr. Puii,

THAT this application be approved subject to the conditions as set out in this minute of the Public Hearing.

- CARRIED UNANIMOUSLY

1100-1114 Burnaby Street

BY-LAW NO. 7516

A By-law to amend
By-law No. 3575, being the
Zoning and Development By-law

THE COUNCIL OF THE CITY OF VANCOUVER, in open meeting assembled, enacts as follows:

1. The "Zoning District Plan" annexed to By-law No. 3575 as Schedule "D" is hereby amended according to the plan marginally numbered Z-446(a) and attached to this By-law as Schedule "A", and in accordance with the explanatory legends, notations and references inscribed thereon, so that the boundaries and districts shown on the Zoning District Plan are varied, amended or substituted to the extent shown on Schedule "A" of this By-law, and Schedule "A" of this By-law is hereby incorporated as an integral part of Schedule "D" of By-law No. 3575.

2. Uses

The area shown included within the heavy black outline on Schedule "A" shall be more particularly described as CD-1(342), and the only uses permitted within the outlined area, subject to such conditions as Council may by resolution prescribe, and the only uses for which development permits will be issued are

- (a) Hotel, limited to an international hostel operated by a non-profit association, and
- (b) Accessory Uses customarily ancillary to the above use.

3. Floor Space Ratio

3.1 The floor space ratio must not exceed 1.80. For the purpose of computing floor space ratio, the site is all parcels covered by this By-law, and is deemed to be 1 606 m², being the site size at time of application for rezoning, prior to any dedications.

3.2 The following will be included in the computation of floor space ratio:

- (a) all floors, including earthen floor, to be measured to the extreme outer limits of the building;
- (b) stairways, fire escapes, elevator shafts and other features which the Director of Planning considers similar, to be measured by their gross cross-sectional areas and included in the measurements for each floor at which they are located.

3.3 The following will be excluded in the computation of floor space ratio:

- (a) patios and roof gardens, provided that the Director of Planning first approves the design of sunroofs and walls;
- (b) where floors are used for off-street parking and loading, bicycle storage, heating and mechanical equipment, or uses which, in the opinion of the Director of Planning, are similar to the foregoing, those floors or portions thereof so used, which are at or below the base surface, provided that the maximum exclusion for a parking space shall not exceed 7.3 m in length;
- (c) areas of undeveloped floors which are located
 - (i) above the highest storey or half-storey and to which there is no permanent means of access other than a hatch; or
 - (ii) adjacent to a storey or half-storey with a ceiling height of less than 1.2 m;
- (d) floors located at or below finished grade with a ceiling height of less than 1.2 m.

4. Height

The maximum building height measured above the base surface is 13.4 m.

5. Off-Street Parking

A minimum of 28 off-street parking spaces must be provided, developed and maintained in accordance with the applicable provisions of the Parking By-law, except that the minimum number of parking spaces can be reduced to 19 if arrangements are made to the satisfaction of the Director of Planning to provide a shuttle service between the site and another similar hostel facility or if 9 additional parking spaces are provided at an off-site location to the satisfaction of the Director of Planning.

6. This By-law comes into force and takes effect on the date of its passing.

DONE AND PASSED in open Council this 16th day of
January , 1996.

"(signed) Philip W. Owen"
Mayor

"(signed) Maria C. Kinsella"
City Clerk

"I hereby certify that the foregoing is a correct copy of a By-law passed by the Council of the City of Vancouver on the 16th day of January 1996, and numbered 7516.

CITY CLERK"

BY-LAW No. 7516 BEING A BY-LAW TO AMEND BY-LAW No. 3575
BEING THE ZONING & DEVELOPMENT BY-LAW

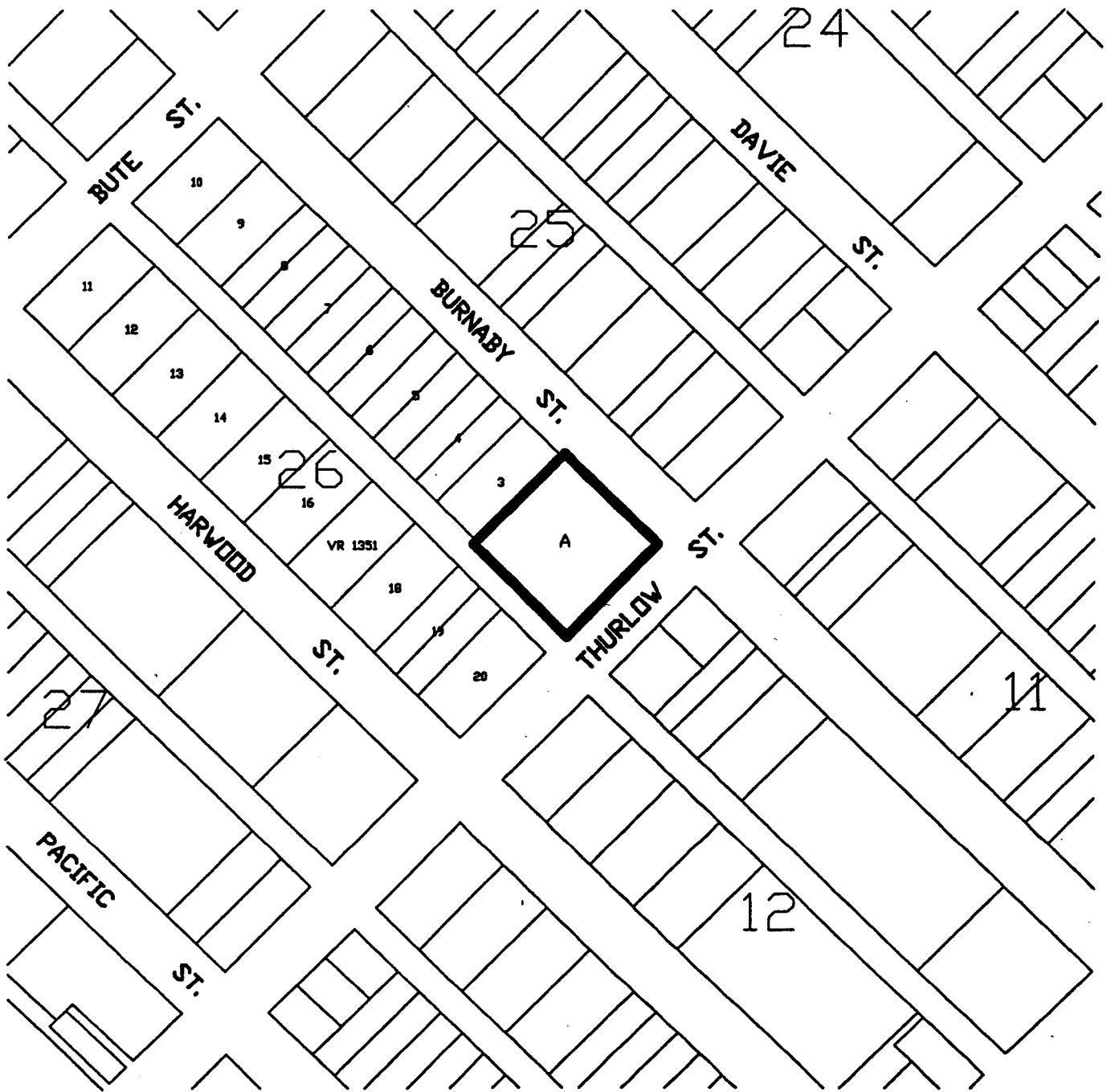

The property outlined in black () is rezoned:
From **RM-5A** To **CD-1**

Z-446(a)

RZ 1100-1114 Burnaby Street

map: 1 of 1

City of Vancouver Planning Department

scale: 1:2000



CITY OF VANCOUVER



MEMORANDUM

RECEIVED
PLANNING DEPARTMENT
JAN 22 1996
NUMBER 50468
REFERRED TO FAB
COPY TO R
ANSWER REC'D

From: CITY CLERK

Date: January 18, 1996
Refer File: 5303-3

To: Ken Dobell, City Manager
Ted Droettboom, General Manager Community Services
Rick Scobie, Director Land Use & Development
Francie Connell, Director Legal Services

Subject: Approval of Form of Development
CD-1 - 1100-1114 Burnaby Street

On January 16, 1996, Vancouver City Council approved the following motion:

MOVED by Cllr. Puil,
SECONDED by Cllr. Price,

THAT the approved form of development for the CD-1 zoned site known as 100-1114 Burnaby Street be approved as illustrated in plans prepared by Harry LeBlond, Architect and approved by the Director of Planning in Development Permit No. 30363 issued October 27, 1964 and as illustrated in plans prepared by Harry LeBlond, Architect and approved by the Director of Planning in Development Permit No. 94456 issued March 3, 1983, and any subsequent minor amendments approved prior to April 28, 1995, provided that the Director of Planning may approve design changes which would not adversely affect with the development character and livability of this site or adjacent properties.

- CARRIED UNANIMOUSLY

COMMITTEE CLERK

JS:ed

BY-LAW NO. 7521

A By-law to amend
By-law No. 6510, being the
Sign By-law

THE COUNCIL OF THE CITY OF VANCOUVER, in open meeting
assembled, enacts as follows:

1. Schedule E to By-law No. 6510 is amended by adding the
following:

"1100-1114 Burnaby St. CD-1(342) 7516 B(FM-1)"

2. This By-law comes into force and takes effect on the date of
its passing.

DONE AND PASSED in open Council this 20th day of
February, 1996.

"(signed) Philip W. Owen"
Mayor

"(signed) Maria C. Kinsella"
City Clerk

"I hereby certify that the foregoing is a correct copy of a By-law
passed by the Council of the City of Vancouver on the 20th day of
February 1996, and numbered 7521.

CITY CLERK"

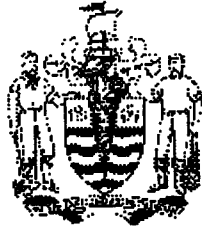

CITY OF VANCOUVER

SPECIAL COUNCIL MEETING MINUTES

FEBRUARY 24, 2000

A Special Meeting of the Council of the City of Vancouver was held on Thursday, February 24, 2000, at 7:35 p.m., in Council Chambers, Third Floor, City Hall, for the purpose of holding a Public Hearing to consider proposed amendments to the Zoning and Development By-law and Official Development Plans.

PRESENT: Mayor Philip Owen
 Councillor Fred Bass
 Councillor Jennifer Clarke
 Councillor Daniel Lee
 Councillor Don Lee
 Councillor Sandy McCormick
 Councillor Sam Sullivan

ABSENT: Councillor Lynne Kennedy
 Councillor Tim Louis
 Councillor Gordon Price (Sick Leave)
 Councillor George Puil (Civic Business)

CITY CLERK'S OFFICE: Tarja Tuominen, Meeting Coordinator

COMMITTEE OF THE WHOLE

MOVED by Cllr. Don Lee,
 SECONDED by Cllr. Daniel Lee,

THAT this Council resolve itself into Committee of the Whole, Mayor Owen in the Chair, to consider proposed amendments to the Zoning and Development By-law and Official Development Plans.

- CARRIED UNANIMOUSLY

1. Text Amendments: District Schedules, Official Development Plans and

CD-1 By-laws - Floor Space Exclusions

[Barrett Commission]

An application by the Director of Current Planning was considered as follows:

Summary: The proposed text amendments would provide floor space exclusions to provide construction incentives to control building envelope leaks.

The Director of Current Planning recommended approval.

Staff Comments

Jacqui Forbes-Roberts, General Manager of Community Services, provided a brief introduction to the report, noting the proposed text amendments would affect new construction and repairs and restoration of existing buildings. Ms. Forbes-Roberts also requested an amendment to the proposed draft by-law to amend By-law 3575 to add RS1 to Section 4.7.3, (d).

Doug Watts, Building Envelope Specialist, with the aid of a slide presentation, described the specifics of the technical and different design issues of the proposed amendments, and explained what steps other municipalities have taken to address the recommendations arising from the Barrett Commission.

Summary of Correspondence

Council was advised the following correspondence was received since the date the application was referred to Public Hearing:

one letter in support of 'Option A'.

Speakers

Mayor Owen called for speakers for and against the application.

The following spoke in support of 'Option A':

John Fowler, Canadian Precast/Prestressed Concrete Institute
Bill McEwen, Masonry Institute of British Columbia (brief filed)
Peter Reese

The foregoing speakers supported 'Option A' based on one or more of the following points:

application of the current FSR calculations has prevented a wide-spread use of precast concrete exterior walls; there have been very few problems with the use of pre-cast concrete, which has proven to be a versatile and durable material;

thicker exterior walls are better walls, because they can include an airspace cavity behind the cladding which provides a "rainscreen" system, more efficient insulation, thicker, more durable cladding materials; current FSR calculations discourage the foregoing;

the proposed changes in FSR definitions will immediately encourage better wall design;

brick and stone-faced walls should be encouraged.

The following generally supported 'Option A' but felt the proposed text amendments should be referred back to staff for further study and discussion with the industry:

John O'Donnell, AIBC
Stuart Howard, Vancouver Planning Coalition

The following is a summary of the foregoing speakers' comments:

Option 'A' is supported in principle; however the text amendments also should address overhangs, balconies, elevated walkways, yard setbacks, and site coverage; staff should accept the electronic calculation of areas and the calculations of the Architect, given under seal; letters of assurance from a building envelope specialist are redundant at an early stage; the proposed text amendments should cover everything instead of the City issuing administrative bulletins to address further changes.

Staff Closing Comments

Ralph Segal, Planner; Eric Fiss, Planner; and Doug Watts responded to the issues raised by the speakers: the proposed text amendments are the result of a fair bit of consultation with the industry; a building envelope specialist is required to be involved in the process earlier as technical details are to be submitted at the development permit stage; staff are taking a further look at other issues, such as recesses, balconies and walkways.

Ms. Forbes-Roberts advised Council may proceed with the proposed amendments to the floor space exclusions and request staff to come back with additional amendments. Staff and the industry would prefer the FSR exclusions not be delayed.

MOVED by Cllr. Don Lee,

A. THAT the application by the Director of Current Planning to amend various District Schedules, Official Development Plans and CD-1 By-laws to provide floor space exclusions to provide construction incentives to control building envelope leaks be approved.

FURTHER THAT the draft By-law 3575, section 4.7.3, be amended as follows:

(d) as clause (h) in the following district schedules:

RS-1 and RS-1S RT-4, etc.

(Italics denote amendment)

B. THAT staff report back on other aspects affecting leakage of buildings, such as overhangs, protection of upper balconies, recesses, etc.

- CARRIED UNANIMOUSLY

RISE FROM COMMITTEE OF THE WHOLE

MOVED by Cllr. Don Lee,

THAT the Committee of the Whole rise and report.

- CARRIED UNANIMOUSLY

ADOPT REPORT OF COMMITTEE OF THE WHOLE

MOVED by Cllr. Clarke,
SECONDED BY Cllr. Don Lee,

THAT the report of the Committee of the Whole be adopted, and the Director of Legal Services be instructed to prepare and bring forward the necessary by-law amendments.

- CARRIED UNANIMOUSLY

The Special Council adjourned at 9:20 p.m.

* * * * *



Comments or questions? You can send us [email](#).

[CITY HOMEPAGE](#)

[GET IN TOUCH](#)

[COMMUNITIES](#)

[SEARCH](#)

(c) 1998 City of Vancouver

EXPLANATION

**Zoning and Development
Various CD-1 by-laws**

Amendments re Exterior Wall Exclusion (Barrett Commission Recommendations)

Following a public hearing on February 24, 2000 Council approved an application, as noted above. There were no prior-to conditions and the Director of Current Planning has advised that the attached by-law can now be enacted to implement Council's resolution.

**Director of Legal Services
14 March 2000**

I:\BYLAWS\WPDOCS\PORTER\CD-1CONS.WPD

Exterior Wall Exclusion

BY-LAW NO. 8169

A By-law to amend
By-laws Nos.

3568 3632 3706 3712 3865 3869 3885 3897 3907 3914 3983 4037 4049 4085 4131
4238 4271 4358 4397 4412 4559 4580 4597 4634 4674 4677 4775 4825 4829 4860
4861 4900 4918 4926 4928 4930 4940 4954 4958 4999 5009 5011 5014 5028 5060
5091 5145 5179 5184 5222 5224 5229 5376 5343 5381 5383 5407 5411 5416 5418
5477 5510 5548 5555 5579 5597 5683 5702 5717 5762 5773 5810 5836 5838 5852
5863 5890 5927 5937 5950 5975 5976 5997 6009 6039 6041 6057 6063 6064 6070
6072 6117 6155 6161 6169 6180 6221 6245 6246 6254 6260 6263 6272 6277 6297
6305 6307 6310 6312 6313 6314 6315 6316 6317 6318 6319 6320 6321 6322 6323
6325 6361 6362 6363 6394 6420 6421 6423 6425 6427 6428 6429 6448 6449 6475
6486 6489 6528 6533 6538 6564 6577 6582 6594 6597 6654 6663 6676 6688 6710
6713 6714 6715 6718 6730 6731 6738 6739 6740 6744 6747 6757 6759 6760 6768
6779 6787 6817 6819 6827 6838 6876 6883 6884 6911 6919 6953 6962 6963 6965
7006 7045 7087 7091 7101 7114 7135 7155 7156 7157 7158 7159 7163 7164 7173
7174 7175 7189 7193 7196 7198 7200 7201 7204 7208 7209 7210 7223 7224 7230
7232 7235 7246 7248 7249 7317 7325 7337 7340 7371 7381 7389 7405 7419 7425
7431 7434 7435 7459 7461 7476 7516 7519 7522 7531 7551 7552 7556 7592 7601
7602 7638 7639 7645 7647 7648 7649 7651 7652 7654 7655 7656 7672 7673 7675
7677 7679 7681 7682 7684 7705 7715 7723 7820 7829 7834 7835 7852 7853 7879
7904 7927 7932 7948 7958 7971 7995 7996 8016 8034 8043 8055 8073 8082 8088
8097 8109 8111 8116 8130 8131

being By-laws which amended the
Zoning and Development By-law
by rezoning areas to CD-1

THE COUNCIL OF THE CITY OF VANCOUVER, in open meeting
assembled, enacts as follows:

1. By-law No. 3907 is amended in Section 2 by deleting the period from the end
of clause (b) and substituting it with a semi-colon and by adding the following clause:

"(c) where exterior walls greater than 152 mm in thickness have been
recommended by a Building Envelope Professional as defined in the Building
By-law, the area of the walls exceeding 152 mm, but to a maximum exclusion
of 152 mm thickness, except that this clause shall not apply to walls in
existence prior to March 14, 2000."

2. By-law No. 4412 is amended in Section 2 by deleting the period from the end of clause (b) and substituting it with a semi-colon and by adding the following clause:

"(c) where exterior walls greater than 152 mm in thickness have been recommended by a Building Envelope Professional as defined in the Building By-law, the area of the walls exceeding 152 mm, but to a maximum exclusion of 152 mm thickness, shall be excluded in the computation of floor space ratio, except that this clause shall not apply to walls in existence prior to March 14, 2000."

3. By-law No. 5376 is amended in Section 2 by deleting the period from the end of subclause (iii) and substituting it with a semi-colon and by adding the following subclause:

"(iv) where exterior walls greater than 152 mm in thickness have been recommended by a Building Envelope Professional as defined in the Building By-law, the area of the walls exceeding 152 mm, but to a maximum exclusion of 152 mm thickness, except that this subclause shall not apply to walls in existence prior to March 14, 2000."

4. By-laws No. 4825 and 6325 are each amended in Section 3 by deleting the period from the end of subclause (ii) and substituting it with a semi-colon and by adding the following subclause:

"(iii) where exterior walls greater than 152 mm in thickness have been recommended by a Building Envelope Professional as defined in the Building By-law, the area of the walls exceeding 152 mm, but to a maximum exclusion of 152 mm thickness, shall be excluded in the computation of floor space ratio, except that this subclause shall not apply to walls in existence prior to March 14, 2000."

5. By-law No. 5343 is amended in Section 3 by deleting the period from the end of clause (iii) and substituting it with a semi-colon and by adding the following clause:

"(iv) where exterior walls greater than 152 mm in thickness have been recommended by a Building Envelope Professional as defined in the Building By-law, the area of the walls exceeding 152 mm, but to a maximum exclusion of 152 mm thickness, except that this clause shall not apply to walls in existence prior to March 14, 2000"

6. By-laws No. 4775, 4829, 5222, 5224, 5773 and 6039 are each amended in Section 3 by deleting the period from the end of clause (b) and substituting it with a semi-colon and by adding the following clause:

"(c) where exterior walls greater than 152 mm in thickness have been recommended by a Building Envelope Professional as defined in the

Building By-law, the area of the walls exceeding 152 mm, but to a maximum exclusion of 152 mm thickness, shall be excluded in the computation of floor space ratio, except that this clause shall not apply to walls in existence prior to March 14, 2000."

7. By-laws No. 4085, 5411, and 5416 are each amended in Section 3 by deleting the period from the end of clause (c) and substituting it with a semi-colon and by adding the following clause:

"(d) where exterior walls greater than 152 mm in thickness have been recommended by a Building Envelope Professional as defined in the Building By-law, the area of the walls exceeding 152 mm, but to a maximum exclusion of 152 mm thickness, except that this clause shall not apply to walls in existence prior to March 14, 2000."

8. By-law No. 5407 is amended in Section 3 by deleting the period from the end of clause (d) and substituting it with a semi-colon and by adding the following clause:

"(e) where exterior walls greater than 152 mm in thickness have been recommended by a Building Envelope Professional as defined in the Building By-law, the area of the walls exceeding 152 mm, but to a maximum exclusion of 152 mm thickness, except that this clause shall not apply to walls in existence prior to March 14, 2000."

9. The By-laws listed below are each amended in Section 3 by adding the following section:

"3.1 Where exterior walls greater than 152 mm in thickness have been recommended by a Building Envelope Professional as defined in the Building By-law, the area of the walls exceeding 152 mm, but to a maximum exclusion of 152 mm thickness, shall be excluded in the computation of floor space ratio, except that this section shall not apply to walls in existence prior to March 14, 2000."

3568 3712 3885 4271 4358 4634 4674 4861 4900 4918 4926 4928
4930 4940 4958 4999 5009 5011 5014 5028 5060 5145 5179 5184
5229 5418 5477 5836 5838 5863 5937 5950 5975 5976 4954 6041
6064 6072 6117 6155 6161 6180 6245 6246 6260 6263 6277 6297
6305 6307 6394 6420 6425 6427 6428 6429 6448 6449 6489 6538
6577 6594 6564 6654 6663 6759 6760 6779 6876 6911

10. By-laws No. 6314 and 6582 are each amended in Section 3.1 by deleting the period from the end of clause (ii) and substituting it with a semi-colon and by adding the following clause:

"(iii) where exterior walls greater than 152 mm in thickness have been recommended by a Building Envelope Professional as defined in the Building By-law, the area of the walls exceeding 152 mm, but to a maximum exclusion of 152 mm thickness, except that this clause shall not apply to walls in existence prior to March 14, 2000."

11. By-law No. 6272 is amended in Section 3.1 by deleting the word "and" from the end of subclause (c)(i), by deleting the period from the end of subclause (c)(ii) and substituting it with a semi-colon and by adding the following subclause:

"(iii) where exterior walls greater than 152 mm in thickness have been recommended by a Building Envelope Professional as defined in the Building By-law, the area of the walls exceeding 152 mm, but to a maximum exclusion of 152 mm thickness, except that this clause shall not apply to walls in existence prior to March 14, 2000."

12. By-law No. 4580 is amended in Section 3.2 by deleting the period at the end of the section and substituting it with a semi-colon, by relettering the existing text as clause (a) and by adding the following clause:

"(b) where exterior walls greater than 152 mm in thickness have been recommended by a Building Envelope Professional as defined in the Building By-law, the area of the walls exceeding 152 mm, but to a maximum exclusion of 152 mm thickness, shall be excluded in the computation of floor space ratio, except that this clause shall not apply to walls in existence prior to March 14, 2000."

13. By-law No. 6884 is amended in Section 3.1 by deleting the word "and" from the end of clause (a), by deleting the period from the end of clause (b) and substituting it with a semi-colon and by adding the following clause:

"(c) where exterior walls greater than 152 mm in thickness have been recommended by a Building Envelope Professional as defined in the Building By-law, the area of the walls exceeding 152 mm, but to a maximum exclusion of 152 mm thickness, except that this clause shall not apply to walls in existence prior to March 14, 2000."

14. By-law No. 5683 is amended in Section 3.2 by deleting the period at the end of this section and substituting it with a semi-colon and by adding the following clause:

"(b) where exterior walls greater than 152 mm in thickness have been recommended by a Building Envelope Professional as defined in the Building By-law, the area of the walls exceeding 152 mm, but to a maximum exclusion of 152 mm thickness, shall be excluded in the computation of floor

space ratio, except that this clause shall not apply to walls in existence prior to March 14, 2000."

15. By-law No. 8088 is amended in Section 3.2 by adding the following clause:

"(d) where exterior walls greater than 152 mm in thickness have been recommended by a Building Envelope Professional as defined in the Building By-law, the area of the walls exceeding 152 mm, but to a maximum exclusion of 152 mm thickness, except that this clause shall not apply to walls in existence prior to March 14, 2000."

16. By-law No. 6009 is amended in Section 3.2 by deleting the period at the end of subclause (e)(vii) and substituting it with a semi-colon and by adding the following clause:

"(f) where exterior walls greater than 152 mm in thickness have been recommended by a Building Envelope Professional as defined in the Building By-law, the area of the walls exceeding 152 mm, but to a maximum exclusion of 152 mm thickness, except that this clause shall not apply to walls in existence prior to March 14, 2000."

17. By-law No. 4677 is amended in Section 3.2 by deleting the period at the end of clause (f) and substituting it with a semi-colon and by adding the following clause:

"(g) where exterior walls greater than 152 mm in thickness have been recommended by a Building Envelope Professional as defined in the Building By-law, the area of the walls exceeding 152 mm, but to a maximum exclusion of 152 mm thickness, except that this clause shall not apply to walls in existence prior to March 14, 2000."

18. The By-laws listed below are each amended in Section 3 by adding the following section:

"3.3 Where exterior walls greater than 152 mm in thickness have been recommended by a Building Envelope Professional as defined in the Building By-law, the area of the walls exceeding 152 mm, but to a maximum exclusion of 152 mm thickness, shall be excluded in the computation of floor space ratio, except that this section shall not apply to walls in existence prior to March 14, 2000."

4238 4860 5579 5717 5810 5852 5890 6057 6070 6310 6312 6313
6316 6320 6361 6363 6423 6528 6714 6715

19. By-law No. 7684 is amended in Section 3.3 by deleting the period from the end of clause (a) and substituting it with a semi-colon and by adding the following clause:

"(b) where exterior walls greater than 152 mm in thickness have been recommended by a Building Envelope Professional as defined in the Building By-law, the area of the walls exceeding 152 mm, but to a maximum exclusion of 152 mm thickness, except that this clause shall not apply to walls in existence prior to March 14, 2000."

20. The By-laws listed below are each amended in Section 3.3 by deleting the and from clause (a) and by deleting the period from the end of clause (b) and substituting it with a semi-colon and by adding the following clause:

"(c) where exterior walls greater than 152 mm in thickness have been recommended by a Building Envelope Professional as defined in the Building By-law, the area of the walls exceeding 152 mm, but to a maximum exclusion of 152 mm thickness, except that this clause shall not apply to walls in existence prior to March 14, 2000."

7705 7459 7435 7434 7419 7389 6718

21. The By-laws listed below are each amended in Section 3.3 by deleting the period from the end of clause (c) and substituting it with a semi-colon and by adding the following clause:

"(d) where exterior walls greater than 152 mm in thickness have been recommended by a Building Envelope Professional as defined in the Building By-law, the area of the walls exceeding 152 mm, but to a maximum exclusion of 152 mm thickness, except that this clause shall not apply to walls in existence prior to March 14, 2000."

5458 5548 5597 6962 7045 7682

22. The By-laws listed below are each amended in Section 3.3 by deleting the period from the end of clause (d) and substituting it with a semi-colon and by adding the following clause:

"(e) where exterior walls greater than 152 mm in thickness have been recommended by a Building Envelope Professional as defined in the Building By-law, the area of the walls exceeding 152 mm, but to a maximum exclusion of 152 mm thickness, except that this clause shall not apply to walls in existence prior to March 14, 2000."

3897 3983 5510 7144 7208 7476 7516 7820 7927 7996

23. The By-laws listed below are each amended in Section 3.3 by deleting the period from the end of clause (e) and substituting it with a semi-colon and by adding the following clause:

" (f) where exterior walls greater than 152 mm in thickness have been recommended by a Building Envelope Professional as defined in the Building By-law, the area of the walls exceeding 152 mm, but to a maximum exclusion of 152 mm thickness, except that this clause shall not apply to walls in existence prior to March 14, 2000."

5091 6486 6676 6688 6713 6730 6787 6817 7159 7337 7531 7552
7556 7645 7652 7715 7835 7971 8111

24. The By-laws listed below are each amended in Section 3.3 by deleting the period from the end of clause (f) and substituting it with a semi-colon and by adding the following clause:

"(g) where exterior walls greater than 152 mm in thickness have been recommended by a Building Envelope Professional as defined in the Building By-law, the area of the walls exceeding 152 mm, but to a maximum exclusion of 152 mm thickness, except that this clause shall not apply to walls in existence prior to March 14, 2000."

4391 4049 4397 4597 6421 6710 6731 6738 6739 6740 6768
6827 6838 6919 6953 6963 6965 7006 7091 7092 7101 7135
7155 7157 7158 7163 7166 7175 7189 7193 7196 7198 7210
7223 7224 7230 7325 7340 7381 7519 7551 7602 7638 7639
7647 7651 7655 7723 7932 7948 8082

25. The By-laws listed below are each amended in Section 3.3 by deleting the period from the end of clause (g) and substituting it with a semi-colon and by adding the following clause:

"(h) where exterior walls greater than 152 mm in thickness have been recommended by a Building Envelope Professional as defined in the Building By-law, the area of the walls exceeding 152 mm, but to a maximum exclusion of 152 mm thickness, except that this clause shall not apply to walls in existence prior to March 14, 2000."

3869 7173 7522 7601 7656 7672 7834 7852 7853 7904 7958

26. By-laws No. 4559, 7209, 7425 and 7431 are each amended in Section 3.3 by deleting the period from the end of clause (h) and substituting it with a semi-colon and by adding the following clause:

"(i) where exterior walls greater than 152 mm in thickness have been recommended by a Building Envelope Professional as defined in the Building By-law, the area of the walls exceeding 152 mm, but to a maximum exclusion of 152 mm thickness, except that this clause shall not apply to walls in existence prior to March 14, 2000."

27. By-laws No. 5997 and 7829 are each amended in Section 3.3 by deleting the period from the end of clause (i) and substituting it with a semi-colon and by adding the following clause:

"(j) where exterior walls greater than 152 mm in thickness have been recommended by a Building Envelope Professional as defined in the Building By-law, the area of the walls exceeding 152 mm, but to a maximum exclusion of 152 mm thickness, except that this clause shall not apply to walls in existence prior to March 14, 2000."

28. The By-laws listed below are each amended in Section 3 by adding the following section:

"3.4 Where exterior walls greater than 152 mm in thickness have been recommended by a Building Envelope Professional as defined in the Building By-law, the area of the walls exceeding 152 mm, but to a maximum exclusion of 152 mm thickness, shall be excluded in the computation of floor space ratio, except that this section shall not apply to walls in existence prior to March 14, 2000."

5762 5927 6315 6317 6318 6319 6321 6323 6362

29. By-law No. 7980 is amended

(a) in Section 3.4 by deleting the period from the end of clause (d) and substituting it with a semi-colon and by adding the following clause:

"(e) where exterior walls greater than 152 mm in thickness have been recommended by a Building Envelope Professional as defined in the Building By-law, the area of the walls exceeding 152 mm, but to a maximum exclusion of 152 mm thickness, except that this clause shall not apply to walls in existence prior to March 14, 2000.", and

(b) in Section 3.7 by deleting the period from the end of clause (f) and substituting it with a semi-colon and by adding the following clause:

"(g) where exterior walls greater than 152 mm in thickness have been recommended by a Building Envelope Professional as defined in the Building By-law, the area of the walls exceeding 152 mm, but to a maximum exclusion of 152 mm thickness, except that this clause shall not apply to walls in existence prior to March 14, 2000."

30. By-laws No. 7087 and 7174 are each amended in Section 3.4 by deleting the period from the end of clause (f) and substituting it with a semi-colon and by adding the following clause:

"(g) where exterior walls greater than 152 mm in thickness have been recommended by a Building Envelope Professional as defined in the Building By-law, the area of the walls exceeding 152 mm, but to a maximum exclusion of 152 mm thickness, except that this clause shall not apply to walls in existence prior to March 14, 2000."

31. By-law No. 7246 is amended in Section 3.4 by deleting the period from the end of clause (h) and substituting it with a semi-colon and by adding the following clause:

"(i) where exterior walls greater than 152 mm in thickness have been recommended by a Building Envelope Professional as defined in the Building By-law, the area of the walls exceeding 152 mm, but to a maximum exclusion of 152 mm thickness, except that this clause shall not apply to walls in existence prior to March 14, 2000."

32. By-laws No. 8034, 8043 and 8116 are each amended in Section 3.4 by deleting the period from the end of clause (f) and substituting it with a semi-colon and by adding the following clause:

"(g) where exterior walls greater than 152 mm in thickness have been recommended by a Building Envelope Professional as defined in the Building By-law, the area of the walls exceeding 152 mm, but to a maximum exclusion of 152 mm thickness, except that this clause shall not apply to walls in existence prior to March 14, 2000."

33. By-laws No. 6322 and 6597 are each amended in Section 3 by adding the following section:

"3.5 Where exterior walls greater than 152 mm in thickness have been recommended by a Building Envelope Professional as defined in the Building By-law, the area of the walls exceeding 152 mm, but to a maximum exclusion of 152 mm thickness, shall be excluded in the computation of floor space ratio, except that this section shall not apply to walls in existence prior to March 14, 2000."

34. By-law No. 8016 is amended in Section 3.5 by deleting the period from the end of clause (g) and substituting it with a semi-colon and by adding the following clause:

"(h) where exterior walls greater than 152 mm in thickness have been recommended by a Building Envelope Professional as defined in the Building By-law, the area of the walls exceeding 152 mm, but to a maximum exclusion of 152 mm thickness, except that this clause shall not apply to walls in existence prior to March 14, 2000."

35. By-law No. 8055 is amended in Section 3.5 by deleting the period from the end of clause (h) and substituting it with a semi-colon and by adding the following clause:

"(i) where exterior walls greater than 152 mm in thickness have been recommended by a Building Envelope Professional as defined in the Building By-law, the area of the walls exceeding 152 mm, but to a maximum exclusion of 152 mm thickness, except that this clause shall not apply to walls in existence prior to March 14, 2000."

36. By-law No. 8130 is amended in Section 3.6 by deleting the period from the end of clause (e) and substituting it with a semi-colon and by adding the following clause:

"(f) where exterior walls greater than 152 mm in thickness have been recommended by a Building Envelope Professional as defined in the Building By-law, the area of the walls exceeding 152 mm, but to a maximum exclusion of 152 mm thickness, except that this clause shall not apply to walls in existence prior to March 14, 2000."

37. By-law No. 7648 is amended in Section 3.6 by deleting the period from the end of clause (f) and substituting it with a semi-colon and by adding the following clause:

"(g) where exterior walls greater than 152 mm in thickness have been recommended by a Building Envelope Professional as defined in the Building By-law, the area of the walls exceeding 152 mm, but to a maximum exclusion of 152 mm thickness, except that this clause shall not apply to walls in existence prior to March 14, 2000."

38. By-laws No. 6063 and 6221 are each amended in Section 3 by adding the following section:

"4.1 Where exterior walls greater than 152 mm in thickness have been recommended by a Building Envelope Professional as defined in the Building By-law, the area of the walls exceeding 152 mm, but to a maximum exclusion of 152 mm thickness, shall be excluded in the computation of floor space ratio, except that this section shall not apply to walls in existence prior to March 14, 2000."

39. By-law No. 5555 is amended in Section 4 by deleting the period from the end of clause (b) and substituting it with a semi-colon and by adding the following clause:

"(c) where exterior walls greater than 152 mm in thickness have been recommended by a Building Envelope Professional as defined in the Building By-law, the area of the walls exceeding 152 mm, but to a maximum exclusion of 152 mm thickness, shall be excluded in the computation of floor space ratio, except that this clause shall not apply to walls in existence prior to March 14, 2000."

40. By-law No. 5705 is amended in Section 4 by adding the following section:

"4.3 Where exterior walls greater than 152 mm in thickness have been recommended by a Building Envelope Professional as defined in the Building By-law, the area of the walls exceeding 152 mm, but to a maximum exclusion of 152 mm thickness, shall be excluded in the computation of floor space ratio, except that this section shall not apply to walls in existence prior to March 14, 2000."

41. By-law No. 7371 is amended in Section 4.3 by deleting the period from the end of clause (a) and substituting it with a semi-colon and by adding the following clause:

"(b) where exterior walls greater than 152 mm in thickness have been recommended by a Building Envelope Professional as defined in the Building By-law, the area of the walls exceeding 152 mm, but to a maximum exclusion of 152 mm thickness, except that this clause shall not apply to walls in existence prior to March 14, 2000."

42. By-law No. 7249 is amended in Section 4.3 by deleting the period from the end of clause (c) and substituting it with a semi-colon and by adding the following clause:

"(d) where exterior walls greater than 152 mm in thickness have been recommended by a Building Envelope Professional as defined in the Building By-law, the area of the walls exceeding 152 mm, but to a maximum exclusion of 152 mm thickness, except that this clause shall not apply to walls in existence prior to March 14, 2000."

43. By-laws No. 5702 and 7673 are each amended in Section 4.3 by deleting the period from the end of clause (d) and substituting it with a semi-colon and by adding the following clause:

"(e) where exterior walls greater than 152 mm in thickness have been recommended by a Building Envelope Professional as defined in the Building By-law, the area of the walls exceeding 152 mm, but to a maximum exclusion of 152 mm thickness, except that this clause shall not apply to walls in existence prior to March 14, 2000."

44. By-laws No. 6819 and 7238 are each amended in Section 4.3 by deleting the period from the end of clause (e) and substituting it with a semi-colon and by adding the following clause:

"(f) where exterior walls greater than 152 mm in thickness have been recommended by a Building Envelope Professional as defined in the Building By-law, the area of the walls exceeding 152 mm, but to a maximum exclusion of 152 mm thickness, except that this clause shall not apply to walls in existence prior to March 14, 2000."

45. The By-laws listed below are each amended in Section 4.3 by deleting the period from the end of clause (f) and substituting it with a semi-colon and by adding the following clause:

"(g) where exterior walls greater than 152 mm in thickness have been recommended by a Building Envelope Professional as defined in the Building By-law, the area of the walls exceeding 152 mm, but to a maximum exclusion of 152 mm thickness, except that this clause shall not apply to walls in existence prior to March 14, 2000."

3632 3706 4131 7649 7995 8073 8097

46. By-law No. 5381 is amended in Section 4.3.3 by adding after the existing text the following:

" - where exterior walls greater than 152 mm in thickness have been recommended by a Building Envelope Professional as defined in the Building By-law, the area of the walls exceeding 152 mm, but to a maximum exclusion of 152 mm thickness, except that this clause shall not apply to walls in existence prior to March 14, 2000."

47. By-law No. 7592 is amended in Section 4.4 by deleting the period from the end of clause (d) and substituting it with a semi-colon and by adding the following clause:

"(e) where exterior walls greater than 152 mm in thickness have been recommended by a Building Envelope Professional as defined in the Building By-law, the area of the walls exceeding 152 mm, but to a maximum exclusion of 152 mm thickness, except that this clause shall not apply to walls in existence prior to March 14, 2000."

48. By-law No. 6883 is amended in Section 4.4 by deleting the period from the end of clause (e) and substituting it with a semi-colon and by adding the following clause:

"(f) where exterior walls greater than 152 mm in thickness have been recommended by a Building Envelope Professional as defined in the Building By-law, the area of the walls exceeding 152 mm, but to a maximum exclusion of 152 mm thickness, except that this clause shall not apply to walls in existence prior to March 14, 2000."

49. By-laws No. 4037 and 7405 are each amended in Section 4.4 by deleting the period from the end of clause (f) and substituting it with a semi-colon and by adding the following clause:

"(g) where exterior walls greater than 152 mm in thickness have been recommended by a Building Envelope Professional as defined in the Building By-law, the area of the walls exceeding 152 mm, but to a maximum

exclusion of 152 mm thickness, except that this clause shall not apply to walls in existence prior to March 14, 2000."

50. By-law No. 7201 is amended in Section 4.5 by deleting the period from the end of clause (c) and substituting it with a semi-colon and by adding the following clause:

"(d) where exterior walls greater than 152 mm in thickness have been recommended by a Building Envelope Professional as defined in the Building By-law, the area of the walls exceeding 152 mm, but to a maximum exclusion of 152 mm thickness, except that this clause shall not apply to walls in existence prior to March 14, 2000."

51. By-law No. 5383 is amended in Section 5 by deleting the period from the end of clause (b) and substituting it with a semi-colon and by adding the following clause:

"(c) where exterior walls greater than 152 mm in thickness have been recommended by a Building Envelope Professional as defined in the Building By-law, the area of the walls exceeding 152 mm, but to a maximum exclusion of 152 mm thickness, except that this clause shall not apply to walls in existence prior to March 14, 2000."

52. By-law No. 6533 is amended in Section 5.2.4 by deleting the period at the end of the existing text and substituting it with a semi-colon and by adding the following:

" - where exterior walls greater than 152 mm in thickness have been recommended by a Building Envelope Professional as defined in the Building By-law, the area of the walls exceeding 152 mm, but to a maximum exclusion of 152 mm thickness, except that this clause shall not apply to walls in existence prior to March 14, 2000."

53. By-law No. 7654 is amended in Section 5.3 by deleting the period from the end of clause (f) and substituting it with a semi-colon and by adding the following clause:

"(g) where exterior walls greater than 152 mm in thickness have been recommended by a Building Envelope Professional as defined in the Building By-law, the area of the walls exceeding 152 mm, but to a maximum exclusion of 152 mm thickness, except that this clause shall not apply to walls in existence prior to March 14, 2000."

54. By-law No. 7677 is amended in Section 5.3 by deleting the period from the end of clause (g) and substituting it with a semi-colon and by adding the following clause:

"(h) where exterior walls greater than 152 mm in thickness have been recommended by a Building Envelope Professional as defined in the Building By-law, the area of the walls exceeding 152 mm, but to a maximum

exclusion of 152 mm thickness, except that this clause shall not apply to walls in existence prior to March 14, 2000."

55. By-laws No. 7675, 7681 and 8109 are each amended in Section 5.3 by deleting the period from the end of clause (h) and substituting it with a semi-colon and by adding the following clause:

"(i) where exterior walls greater than 152 mm in thickness have been recommended by a Building Envelope Professional as defined in the Building By-law, the area of the walls exceeding 152 mm, but to a maximum exclusion of 152 mm thickness, except that this clause shall not apply to walls in existence prior to March 14, 2000."

56. By-laws No. 3865 and 6475 are each amended in Section 5.3.3 by deleting the period from the end of the existing text and substituting it with a semi-colon and by adding the following:

" - where exterior walls greater than 152 mm in thickness have been recommended by a Building Envelope Professional as defined in the Building By-law, the area of the walls exceeding 152 mm, but to a maximum exclusion of 152 mm thickness, except that this clause shall not apply to walls in existence prior to March 14, 2000."

57. By-law No. 7879 is amended in Section 5.4 by deleting the period from the end of clause (f) and substituting it with a semi-colon and by adding the following clause:

"(g) where exterior walls greater than 152 mm in thickness have been recommended by a Building Envelope Professional as defined in the Building By-law, the area of the walls exceeding 152 mm, but to a maximum exclusion of 152 mm thickness, except that this clause shall not apply to walls in existence prior to March 14, 2000."

58. By-law No. 8131 is amended in Section 5.4 by deleting the period from the end of clause (j) and substituting it with a semi-colon and by adding the following clause:

"(k) where exterior walls greater than 152 mm in thickness have been recommended by a Building Envelope Professional as defined in the Building By-law, the area of the walls exceeding 152 mm, but to a maximum exclusion of 152 mm thickness, except that this clause shall not apply to walls in existence prior to March 14, 2000."

59. By-law No. 6169 is amended in Section 6 by adding the following section:

"6.1 Where exterior walls greater than 152 mm in thickness have been recommended by a Building Envelope Professional as defined in the

Building By-law, the area of the walls exceeding 152 mm, but to a maximum exclusion of 152 mm thickness, shall be excluded in the computation of floor space ratio, except that this section shall not apply to walls in existence prior to March 14, 2000."

60. By-law No. 7679 is amended in Section 6.3 by deleting the period from the end of clause (d) and substituting it with a semi-colon and by adding the following clause:

"(e) where exterior walls greater than 152 mm in thickness have been recommended by a Building Envelope Professional as defined in the Building By-law, the area of the walls exceeding 152 mm, but to a maximum exclusion of 152 mm thickness, except that this clause shall not apply to walls in existence prior to March 14, 2000."

61. By-law No. 7317 is amended in Section 6.3 by deleting the period from the end of clause (f) and substituting it with a semi-colon and by adding the following clause:

"(g) where exterior walls greater than 152 mm in thickness have been recommended by a Building Envelope Professional as defined in the Building By-law, the area of the walls exceeding 152 mm, but to a maximum exclusion of 152 mm thickness, except that this clause shall not apply to walls in existence prior to March 14, 2000."

62. By-laws No. 7156, 7200, and 7232 are each amended in Section 6.3 by deleting the period from the end of clause (g) and substituting it with a semi-colon and by adding the following clause:

"(h) where exterior walls greater than 152 mm in thickness have been recommended by a Building Envelope Professional as defined in the Building By-law, the area of the walls exceeding 152 mm, but to a maximum exclusion of 152 mm thickness, except that this clause shall not apply to walls in existence prior to March 14, 2000."

63. By-law No. 7461 is amended in Section 6.3 of Schedule B by deleting the period from the end of clause (h) and substituting it with a semi-colon and by adding the following clause:

"(i) where exterior walls greater than 152 mm in thickness have been recommended by a Building Envelope Professional as defined in the Building By-law, the area of the walls exceeding 152 mm, but to a maximum exclusion of 152 mm thickness, except that this clause shall not apply to walls in existence prior to March 14, 2000."

64. By-law No. 7248 is amended in Section 6.3 by deleting the period from the end of clause (i) and substituting it with a semi-colon and by adding the following clause:

"(j) where exterior walls greater than 152 mm in thickness have been recommended by a Building Envelope Professional as defined in the Building By-law, the area of the walls exceeding 152 mm, but to a maximum exclusion of 152 mm thickness, except that this clause shall not apply to walls in existence prior to March 14, 2000."

65. By-law No. 6744 is amended in Section 6.3 by deleting the period from the end of clause (j) and substituting it with a semi-colon and by adding the following clause:

"(k) where exterior walls greater than 152 mm in thickness have been recommended by a Building Envelope Professional as defined in the Building By-law, the area of the walls exceeding 152 mm, but to a maximum exclusion of 152 mm thickness, except that this clause shall not apply to walls in existence prior to March 14, 2000."

66. By-laws No. 6747 and 7204 are each amended in Section 7.3 of Schedule B, by deleting the period from the end of clause (f) and substituting it with a semi-colon and by adding the following clause:

"(g) where exterior walls greater than 152 mm in thickness have been recommended by a Building Envelope Professional as defined in the Building By-law, the area of the walls exceeding 152 mm, but to a maximum exclusion of 152 mm thickness, except that this clause shall not apply to walls in existence prior to March 14, 2000."

67. By-law No. 6757 is amended in Section 7.3 by deleting the period from the end of clause (g) and substituting it with a semi-colon and by adding the following clause:

"(h) where exterior walls greater than 152 mm in thickness have been recommended by a Building Envelope Professional as defined in the Building By-law, the area of the walls exceeding 152 mm, but to a maximum exclusion of 152 mm thickness, except that this clause shall not apply to walls in existence prior to March 14, 2000."

68. By-law No. 6254 is amended in Section 8 by deleting the period from the end of the second clause (a), which clause ends with the word "computation", and substituting a semi-colon and by inserting the following clause:

"(b) where exterior walls greater than 152 mm in thickness have been recommended by a Building Envelope Professional as defined in the Building By-law, the area of the walls exceeding 152 mm, but to a maximum exclusion of 152 mm thickness, except that this clause shall not apply to walls in existence prior to March 14, 2000;"

69.

This By-law comes into force and takes effect on the date of its passing.

DONE AND PASSED in open Council this 14th day of March , 2000.

(Signed) Philip W. Owen
Mayor

(Signed) Ulli S. Watkiss
City Clerk

"I hereby certify that the foregoing is a correct copy of a By-law passed by the Council of the City of Vancouver on the 14th day of March 2000, and numbered 8169.

CITY CLERK"