



# **City of Vancouver** *Zoning and Development By-law*

Community Services, 453 W. 12th Ave Vancouver, BC V5Y 1V4 ☎ 604.873.7344 fax 604.873.7060  
[planning@vancouver.ca](mailto:planning@vancouver.ca)

## CD-1 (313)

### *2010 Harrison Drive*

### **By-law No. 7196**

*(Being a By-law to Amend By-law 3575, being the Zoning and Development By-law)*

**Effective October 19, 1993**

*(Amended up to and including By-law No. 9674, dated June 24, 2008)*

1 *[Section 1 is not reprinted here. It contains a Standard clause amending Schedule D (Zoning District Plan) to reflect this rezoning to CD-1.]*

2 **Uses**

The area shown included within the heavy black outline on Schedule “A” shall be more particularly described as CD-1(313), and the only uses permitted within the outlined area, subject to such conditions as Council may by resolution prescribe, and the only uses for which development permits will be issued are:

- (a) Community Care Facility - Class B; [9674; 08 06 24]
- (b) Accessory Uses customarily ancillary to the above use.

3 **Floor Space Ratio**

**3.1** The maximum floor space ratio shall be 0.85. For the purpose of computing the-floor space ratio, the site shall be all parcels covered by this By-law, and shall be deemed to be 9 803.7 m<sup>2</sup>, being the site size at time of application for rezoning, prior to any dedications.

**3.2** The following shall be included in the computation of floor space ratio:

- (a) all floors having a minimum ceiling height of 1.2 m, including earthen floor, both above and below ground level, to be measured to the extreme outer limits of the building;
- (b) stairways, fire escapes, elevator shafts and other features which the Director of Planning considers similar, to be measured by their gross cross-sectional areas and included in the measurements for each floor at which they are located.

**3.3** The following shall be excluded in the computation of floor space ratio:

- (a) open residential balconies or sundecks, and any other appurtenances which, in the opinion of the Director of Planning, are similar to the foregoing;
- (b) patios and roof gardens, provided that the Director of Planning first approves the design of sunroofs and walls;
- (c) where floors are used for off-street parking and loading, bicycle storage, heating and mechanical equipment, or uses which in the opinion of the Director of Planning are similar to the foregoing, those floors or portions thereof so used, which are at or below the base surface, provided that the maximum exclusion for a parking space shall not exceed 7.3 m in length;
- (d) amenity areas, including day care facilities, recreation facilities, and meeting rooms, to a maximum total of 10 percent of the total building-floor area;
- (e) areas of undeveloped floors located above the highest storey or half-storey, or adjacent to a storey or half-storey, with a ceiling height of less than 1.2 m, and to which there is no permanent means of access other than a hatch;
- (f) all residential storage space above or below base surface, except that if the residential storage space above base surface exceeds 3.7 m<sup>2</sup> per dwelling unit, there will be no exclusion for any of the residential storage space above base surface for that unit; [8760; 03 12 09]
- (g) where exterior walls greater than 152 mm in thickness have been recommended by a Building Envelope Professional as defined in the Building By-law, the area of the walls exceeding 152 mm, but to a maximum exclusion of 152 mm thickness, except that this clause shall not apply to walls in existence prior to March 14, 2000. [8169; 00 03 14]

**Note:** *Information included in square brackets [ ] identifies the by-law numbers and dates for the amendments to By-law No. 7196 or provides an explanatory note.*

- 4 Height
- 4.1 The maximum building height measured above the base surface shall be 12.0 m.
- 5 Off Street Parking and Loading  
Off-street parking and loading spaces shall be provided, developed and maintained in accordance with the Parking By-law, except that a minimum of 42, underground and 7 surface off-street parking spaces and a minimum of 1 off-street loading space shall be provided.
- 6 By-law Nos. 4346, 4492 and 4676 are repealed.
- 7 *[Section 7 is not reprinted here. It contains a standard clause including the Mayor and City Clerk's signature to pass the by-law and certify the by-law number and date of enactment.]*

By-law No. 7196 being a By-law to amend By-law No. 3575, being the Zoning and Development By-law

The property shown below ( ——— ) outlined in black is rezoned from CD-1 to New CD-1

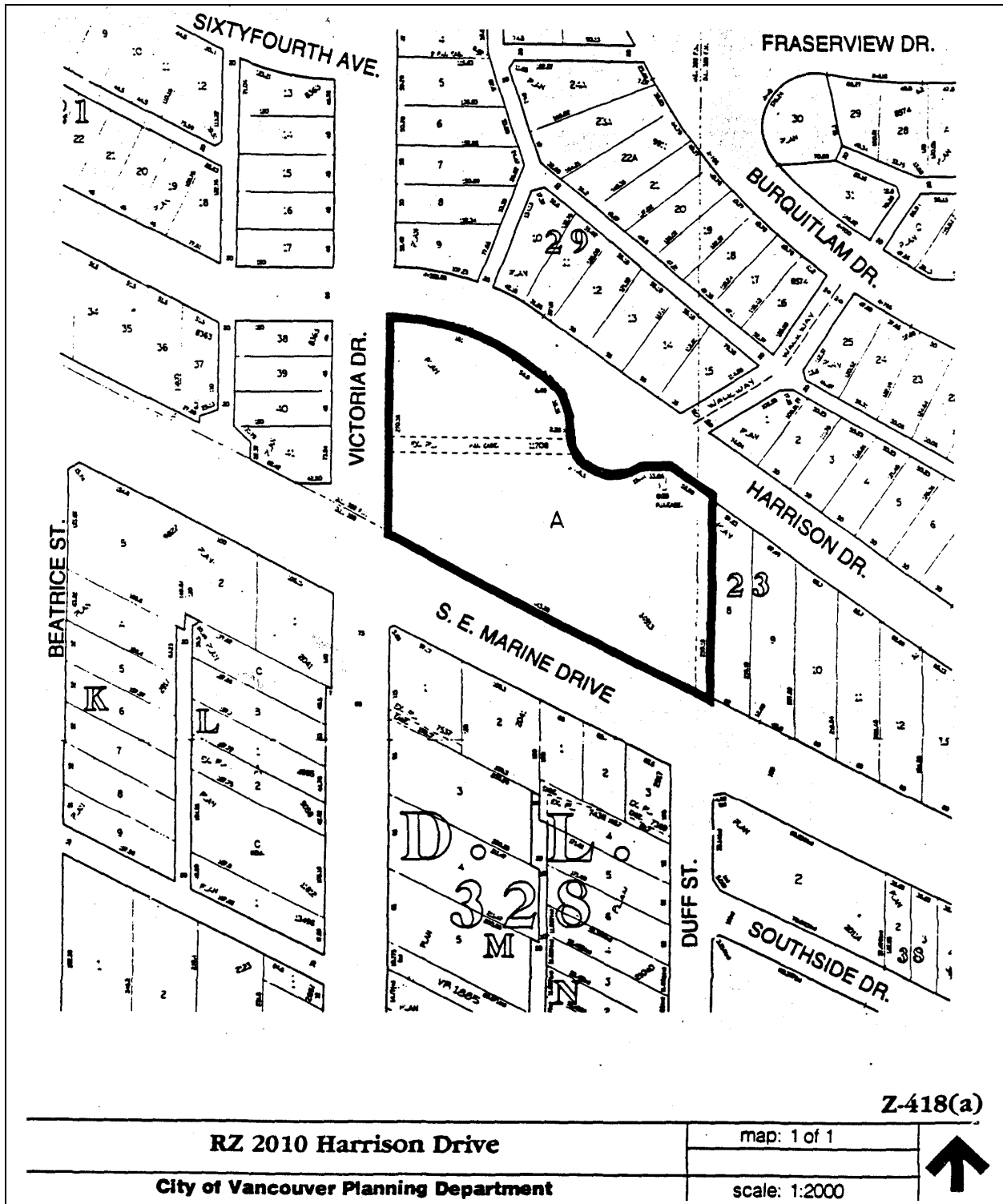

CITY OF VANCOUVER  
SPECIAL COUNCIL MEETING

A Special Meeting of the Council of the City of Vancouver was held on Thursday, July 29, 1993, at 7:30 p.m., in the Council Chamber, City Hall, for the purpose of holding a Public Hearing to amend the Zoning and Development By-law.

PRESENT:

Mayor Campbell  
Councillors Bellamy, Chan, Davies,  
Eriksen, Kennedy, Owen,  
Price, Pull, Rankin  
and Wilson

CLERK TO THE COUNCIL: D. Back

COMMITTEE OF THE WHOLE

MOVED by Cllr. Bellamy,  
SECONDED by Cllr. Wilson,

THAT this Council resolve itself into Committee of the Whole, Mayor Campbell in the Chair, to consider proposed amendments to the Zoning and Development By-law.

- CARRIED UNANIMOUSLY

1. Rezoning: 2010 Harrison Drive

93-092

An application by The Buttjes Group was considered as follows:

REZONING: 2010 HARRISON DRIVE (Lot A, Blocks 23 and 29A,  
Fraserview, Plan 14913)

Present Zoning: CD-1 Comprehensive Development District  
Proposed Zoning: CD-1 Comprehensive Development District

- (i) If approved, this rezoning would permit replacement of a 3-storey wing of the existing German Canadian Care Home with a 4-storey special care and support services wing. The maximum floor space ratio would be 0.85 and maximum height would be 12.0 m (40 ft.). Comprehensive Development District By-law Nos. 4676, 4346 and 4492 would be repealed, in order to consolidate these districts into a new CD-1 By-law.
- (ii) Any consequential amendments.

Clause No. 1 cont'd

The Director of Planning recommended approval, subject to the following conditions proposed for adoption by resolution of Council:

- (a) That the proposed form of development be approved by Council in principle, generally as prepared by The Buttjes Group, Architects, and stamped "Received City Planning Department, March 19, 1993", provided that the Director of Planning may allow minor alterations to this form of development when approving the detailed scheme of development as outlined in (b) below.
- (b) That, prior to approval by Council of the form of development, the applicant shall obtain approval of a development application by the Director of Planning, who shall have particular regard to the following:
  - (i) provision of natural light to the level two nursing station and activity room;
  - (ii) design development to integrate flat and pitched roof forms particularly in the northeast corner of the special care wing;
  - (iii) elimination of all fourth floor windows on the east elevation of the special care wing;
  - (iv) provision of a pitched roof over the full length of the east elevation of the special care wing to a maximum elevation of 72.5 m (238 ft.), to be compatible with the pitched roof over the north elevation;
  - (v) reduction of the number of dormers on the north elevation of the special care wing;
  - (vi) recessing of remaining dormer windows on the north elevation of the special care wing;
  - (vii) reduction of building height to a maximum of 12 m (per By-law) and strive for further reduction to 11.9 m (39 ft.);

Clause No. 1 cont'd

- (viii) reduction in slope of the driveway from Harrison Drive to a maximum of 8%, possibly including relocation of the sidewalk crossing to achieve this; and
  - (ix) provision of garbage and recycling facilities, to the satisfaction of the City Engineer.
- (c) That, prior to enactment of the CD-1 By-law, the registered owner shall, at no cost to the City:
- (i) make suitable arrangements, to the satisfaction of the City Engineer, to relocate the 0.46 m (18 in.) sewer and provide a new right-of-way, or re-design the building to accommodate the existing sewer;
  - (ii) make suitable arrangements, to the satisfaction of the City Engineer, for upgrading of existing water service to ensure adequate fire protection, including installation of a new fire hydrant within 45 m (147.6 ft.) of the building's Fire Department connection. Since any modification to the water service is at the applicant's expense, it may be advisable for the applicant to re-design the building to provide for firewalls, thus reducing the requirement for water service upgrading; and
  - (iii) make suitable arrangements, to the satisfaction of the City Engineer, for undergrounding of any new electrical or telephone services within and adjacent to the site from the closest existing suitable service point.

Clause No. 1 cont'd

The agenda material included the following summary of the proposed changes:

	Current Status	Proposed Amendments
Zone	CD-1	CD-1
Use	Personal Care Home	Special Needs Residential Facility
Maximum FSR	Approx. 0.55	0.85
Maximum Height	12.0 m (39.4 ft.)	12.0 m (39.4 ft.)

A summary of the correspondence received indicated there were eight letters of opposition received, expressing concerns regarding the following:

- loss of views due to building height;
- increased traffic and noise;
- design of the development is out of character with the neighbourhood;
- disruption caused in the neighbourhood during construction.

Ms. Pat Johnston, Planner, reviewed the application and advised the CD-1 by-law would permit the German Canadian Care Home to replace one three-storey wing of the existing facility with a four-storey building containing a similar number of beds in a larger floor area. This is intended to meet current Provincial standards for care of Alzheimer patients. This new structure would also rationalize the location of kitchen and staff facilities, and provide underground parking with access from Victoria Drive. In order to address concerns raised by area residents, a reduced height limit is recommended which would be at least one foot lower than the original proposal, and one-half foot lower than the existing facility.



Clause No. 1 cont'd

In response to community concern regarding the institutional appearance of the building, conditions are recommended to eliminate all four-storey windows on the east elevation of the building, provide a pitched roof, reduce the number of dormers on the north elevation, and inset the windows in the remaining dormers. The revised design would have no view impact and would appear less institutional.

Mr. Dirk Buttjes, Architect, noted that on February 12, 1993, the Provincial Minister of Health announced that funding would be available for the special care wing and new central services facility to replace the existing 62-bed wing. On April 14, 1993, the proposal received the support of the Urban Design Panel, which was followed in May by public meetings. Mr. Buttjes reviewed various issues which have been raised by area residents, including views encroachment, building character, privacy, and traffic/parking. Mr. Buttjes advised that in an effort to compromise and accommodate these concerns, the Society is willing to reduce the number of beds on the top floor of the north/south wing and thereby reduce the number of beds from 19 to 9. The building design has been revised to provide a sloped roof with hipped ends, as well as reduce the overall building height by one foot in order to reduce the views impact. The number of windows and dormers have been reduced in an effort to make the appearance of the building more in keeping with the neighbourhood. The number of off-street parking stalls would be increased from 25 to 49 cars, and all but seven of the parking spaces would be provided underground. Access to the underground parking and loading area would be from Victoria Drive and not Harrison Drive.

Mr. Buttjes requested that condition (b)(iii) be amended to read:

- (iii) elimination of all fourth floor windows on the east elevation of the north/south portion of the special care wing;

Underlining denotes amendment

The foregoing amendment to the condition of approval would allow greater flexibility in planning the already scaled-down level four. After 30 years, the facility is in need of a major upgrade. The rezoning would enable the Society to develop a state-of-the-art special care wing, and consolidate and upgrade central services. The additional floor space and density are required to meet the more stringent spacial requirements of the multi-level care guidelines, and to provide the other amenities as proposed.

Clause No. 1 cont'd

Mr. Rudolph Aulinger, Executive Director, German Canadian Care Home, advised the facility currently houses 88 hard-to-manage people, and there are 150 on the waiting list. The current facility is old, unfunctional, uneconomic, and labour intensive. If provision is not made at this time to care for the elderly, society as a whole will be facing a real housing problem for these people in the future.

Ms. Shirley Thompson, 3200 Block East 58th Avenue, indicated she was opposed to the project.

Mr. Kay Wei Mui, 2000 Harrison Drive, expressed opposition to the project on the basis of parking and traffic. If the parking problem can be addressed through the design of the development, this would substantially address his concerns.

Mr. Heinz StuhlmueLLer, German Canadian Care Benevolent Society of B.C., advised the Board has met with the neighbourhood. The problems associated with traffic and parking will be considerably less than at present due to the change in the parking access from Harrison Drive to Victoria Drive. The proposal not only represents a more dignified life for seniors, but also better working conditions for the staff.

Mr. Hans Vontiesenhausen, German Canadian Care Benevolent Society of B.C., encouraged Council to support the rezoning application. The Society has gone to great lengths to accommodate the concerns of the neighbourhood and, in the long term, the neighbourhood will be better served with a stable operating facility in its proposed form.

Ms. Balvir Bahia, 2000 Block Harrison Drive, expressed concern regarding the loss of privacy which would result from the new facility, while the facility would only gain a total of five beds. There is currently a parking problem in the area as a result of this facility.

Clause No. 1 cont'd

Ms. Linda Ruiz, Coordinator, Facilities - Continuing Care Division, advised the Vancouver Health Department supports this proposal as it is at the top of the department's priority list. The German Canadian West Wing project, which was opened in 1983, was the first special care facility to open in Vancouver. The existing facility was established on the model of four beds per room, whereas the new facility would be developed around single rooms. Council was encouraged to support this application.

MOVED by Cllr. Bellamy,

THAT the application be approved, subject to the conditions set out in this Minute of the Public Hearing, together with an amendment to condition (b)(iii) to read as follows:

- (b)(iii) elimination of all fourth floor windows on the east elevation of the north/south portion of the special care wing.

- CARRIED UNANIMOUSLY

BY-LAW NO. 7196

A By-law to amend By-law No. 3575,  
being the Zoning and Development By-law and to  
repeal By-law Nos. 4346, 4492 and 4676  
being by-laws which regulated uses

THE COUNCIL OF THE CITY OF VANCOUVER in open meeting assembled,  
enacts as follows:

1. The "Zoning District Plan" annexed to By-law No. 3575 as Schedule "D" is hereby amended according to the plan marginally numbered Z-418(a) and attached to this By-law as Schedule "A", and in accordance with the explanatory legends, notations and references inscribed thereon, so that the boundaries and districts shown on the Zoning District Plan are varied, amended or substituted to the extent shown on Schedule "A" of this By-law, and Schedule "A" of this By-law is hereby incorporated as an integral part of Schedule "D" of By-law No. 3575.

2. Uses

The area shown included within the heavy black outline on Schedule "A" shall be more particularly described as CD-1(313), and the only uses permitted within the outlined area, subject to such conditions as Council may by resolution prescribe, and the only uses for which development permits will be issued are:

- (a) Special Needs Residential Facility - Community Care - Class B;
- (b) Accessory Uses customarily ancillary to the above use.

3. Floor Space Ratio

3.1 The maximum floor space ratio shall be 0.85. For the purpose of computing the floor space ratio, the site shall be all parcels covered by this By-law, and shall be deemed to be 9 803.7 m<sup>2</sup>, being the site size at time of application for rezoning, prior to any dedications.

3.2 The following shall be included in the computation of floor space ratio:

- (a) all floors having a minimum ceiling height of 1.2 m, including earthen floor, both above and below ground level, to be measured to the extreme outer limits of the building;
- (b) stairways, fire escapes, elevator shafts and other features which the Director of Planning considers similar, to be measured by

their gross cross-sectional areas and included in the measurements for each floor at which they are located.

3.3 The following shall be excluded in the computation of floor space ratio:

- (a) open residential balconies or sundecks, and any other appurtenances which, in the opinion of the Director of Planning, are similar to the foregoing;
- (b) patios and roof gardens, provided that the Director of Planning first approves the design of sunroofs and walls;
- (c) where floors are used for off-street parking and loading, bicycle storage, heating and mechanical equipment, or uses which in the opinion of the Director of Planning are similar to the foregoing, those floors or portions thereof so used, which are at or below the base surface, provided that the maximum exclusion for a parking space shall not exceed 7.3 m in length;
- (d) amenity areas, including day care facilities, recreation facilities, and meeting rooms, to a maximum total of 10 percent of the total building floor area;
- (e) areas of undeveloped floors located above the highest storey or half-storey, or adjacent to a storey or half-storey, with a ceiling height of less than 1.2 m, and to which there is no permanent means of access other than a hatch;
- (f) residential storage space provided that where the space is provided at or above base surface, the maximum exclusion shall be 3.7 m<sup>2</sup> per dwelling unit.

4. Height

- 4.1 The maximum building height measured above the base surface shall be 12.0 m.

5. Off Street Parking and Loading

Off-street parking and loading spaces shall be provided, developed and maintained in accordance with the Parking By-law, except that a minimum of 42 underground and 7 surface off-street parking spaces and a minimum of 1 off-street loading space shall be provided.

6. By-law Nos. 4346, 4492 and 4676 are repealed.

7. This By-law comes into force and takes effect on the date of its passing.

DONE AND PASSED in open Council this 19th day of October , 1993.

(signed) Gordon Campbell  
Mayor

(signed) Maria C. Kinsella  
City Clerk

"I hereby certify that the foregoing is a correct copy of a By-law passed by the Council of the City of Vancouver on the 19th day of October 1993, and numbered 7196.

CITY CLERK"

BY-LAW No. 7196 BEING A BY-LAW TO AMEND BY-LAW No. 3575  
BEING THE ZONING & DEVELOPMENT BY-LAW

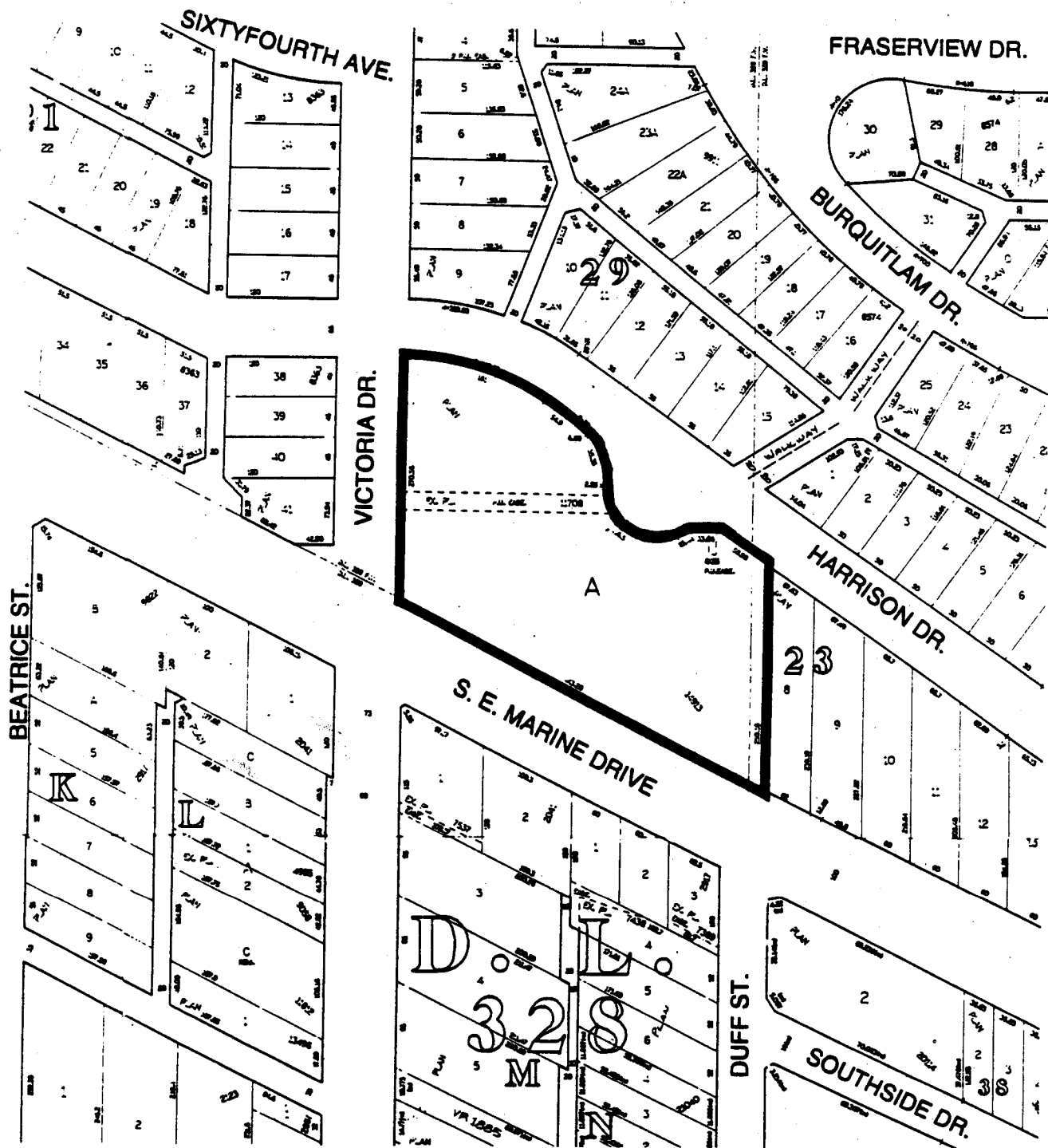

The property outlined in black (A) is rezoned:  
From **CD-1** To **New CD-1**

**Z-418(a)**

**RZ 2010 Harrison Drive**

map: 1 of 1

**City of Vancouver Planning Department**

scale: 1:2000



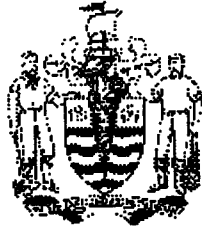

**CITY OF VANCOUVER**

**SPECIAL COUNCIL MEETING MINUTES**

**FEBRUARY 24, 2000**

A Special Meeting of the Council of the City of Vancouver was held on Thursday, February 24, 2000, at 7:35 p.m., in Council Chambers, Third Floor, City Hall, for the purpose of holding a Public Hearing to consider proposed amendments to the Zoning and Development By-law and Official Development Plans.

**PRESENT:** Mayor Philip Owen  
 Councillor Fred Bass  
 Councillor Jennifer Clarke  
 Councillor Daniel Lee  
 Councillor Don Lee  
 Councillor Sandy McCormick  
 Councillor Sam Sullivan

**ABSENT:** Councillor Lynne Kennedy  
 Councillor Tim Louis  
 Councillor Gordon Price (Sick Leave)  
 Councillor George Puil (Civic Business)

**CITY CLERK'S OFFICE:** Tarja Tuominen, Meeting Coordinator

**COMMITTEE OF THE WHOLE**

MOVED by Cllr. Don Lee,  
 SECONDED by Cllr. Daniel Lee,

THAT this Council resolve itself into Committee of the Whole, Mayor Owen in the Chair, to consider proposed amendments to the Zoning and Development By-law and Official Development Plans.

- CARRIED UNANIMOUSLY

**1. Text Amendments: District Schedules, Official Development Plans and**

**CD-1 By-laws - Floor Space Exclusions**



### [Barrett Commission]

An application by the Director of Current Planning was considered as follows:

Summary: The proposed text amendments would provide floor space exclusions to provide construction incentives to control building envelope leaks.

The Director of Current Planning recommended approval.

### Staff Comments

Jacqui Forbes-Roberts, General Manager of Community Services, provided a brief introduction to the report, noting the proposed text amendments would affect new construction and repairs and restoration of existing buildings. Ms. Forbes-Roberts also requested an amendment to the proposed draft by-law to amend By-law 3575 to add RS1 to Section 4.7.3, (d).

Doug Watts, Building Envelope Specialist, with the aid of a slide presentation, described the specifics of the technical and different design issues of the proposed amendments, and explained what steps other municipalities have taken to address the recommendations arising from the Barrett Commission.

### Summary of Correspondence

Council was advised the following correspondence was received since the date the application was referred to Public Hearing:

one letter in support of 'Option A'.

### Speakers

Mayor Owen called for speakers for and against the application.

The following spoke in support of 'Option A':

John Fowler, Canadian Precast/Prestressed Concrete Institute  
Bill McEwen, Masonry Institute of British Columbia (brief filed)  
Peter Reese

The foregoing speakers supported 'Option A' based on one or more of the following points:

application of the current FSR calculations has prevented a wide-spread use of precast concrete exterior walls; there have been very few problems with the use of pre-cast concrete, which has proven to be a versatile and durable material;

thicker exterior walls are better walls, because they can include an airspace cavity behind the cladding which provides a "rainscreen" system, more efficient insulation, thicker, more durable cladding materials; current FSR calculations discourage the foregoing;

the proposed changes in FSR definitions will immediately encourage better wall design;

brick and stone-faced walls should be encouraged.

The following generally supported 'Option A' but felt the proposed text amendments should be referred back to staff for further study and discussion with the industry:

John O'Donnell, AIBC  
Stuart Howard, Vancouver Planning Coalition

The following is a summary of the foregoing speakers' comments:

Option 'A' is supported in principle; however the text amendments also should address overhangs, balconies, elevated walkways, yard setbacks, and site coverage; staff should accept the electronic calculation of areas and the calculations of the Architect, given under seal; letters of assurance from a building envelope specialist are redundant at an early stage; the proposed text amendments should cover everything instead of the City issuing administrative bulletins to address further changes.

### **Staff Closing Comments**

Ralph Segal, Planner; Eric Fiss, Planner; and Doug Watts responded to the issues raised by the speakers: the proposed text amendments are the result of a fair bit of consultation with the industry; a building envelope specialist is required to be involved in the process earlier as technical details are to be submitted at the development permit stage; staff are taking a further look at other issues, such as recesses, balconies and walkways.

Ms. Forbes-Roberts advised Council may proceed with the proposed amendments to the floor space exclusions and request staff to come back with additional amendments. Staff and the industry would prefer the FSR exclusions not be delayed.

MOVED by Cllr. Don Lee,

A. THAT the application by the Director of Current Planning to amend various District Schedules, Official Development Plans and CD-1 By-laws to provide floor space exclusions to provide construction incentives to control building envelope leaks be approved.

FURTHER THAT the draft By-law 3575, section 4.7.3, be amended as follows:

(d) as clause (h) in the following district schedules:

*RS-1 and RS-1S RT-4, etc.*

*(Italics denote amendment)*

B. THAT staff report back on other aspects affecting leakage of buildings, such as overhangs, protection of upper balconies, recesses, etc.

- CARRIED UNANIMOUSLY

**RISE FROM COMMITTEE OF THE WHOLE**

MOVED by Cllr. Don Lee,

THAT the Committee of the Whole rise and report.

- CARRIED UNANIMOUSLY

**ADOPT REPORT OF COMMITTEE OF THE WHOLE**

MOVED by Cllr. Clarke,  
SECONDED BY Cllr. Don Lee,

THAT the report of the Committee of the Whole be adopted, and the Director of Legal Services be instructed to prepare and bring forward the necessary by-law amendments.

- CARRIED UNANIMOUSLY

The Special Council adjourned at 9:20 p.m.

\* \* \* \* \*



---

Comments or questions? You can send us [email](#).

[CITY HOMEPAGE](#)

[GET IN TOUCH](#)

[COMMUNITIES](#)

[SEARCH](#)

(c) 1998 City of Vancouver

**EXPLANATION**

**Zoning and Development  
Various CD-1 by-laws**

**Amendments re Exterior Wall Exclusion (Barrett Commission Recommendations)**

Following a public hearing on February 24, 2000 Council approved an application, as noted above. There were no prior-to conditions and the Director of Current Planning has advised that the attached by-law can now be enacted to implement Council's resolution.

**Director of Legal Services  
14 March 2000**

I:\BYLAWS\WPDOCS\PORTER\CD-1CONS.WPD

Exterior Wall Exclusion

BY-LAW NO. 8169

A By-law to amend  
By-laws Nos.

3568 3632 3706 3712 3865 3869 3885 3897 3907 3914 3983 4037 4049 4085 4131  
4238 4271 4358 4397 4412 4559 4580 4597 4634 4674 4677 4775 4825 4829 4860  
4861 4900 4918 4926 4928 4930 4940 4954 4958 4999 5009 5011 5014 5028 5060  
5091 5145 5179 5184 5222 5224 5229 5376 5343 5381 5383 5407 5411 5416 5418  
5477 5510 5548 5555 5579 5597 5683 5702 5717 5762 5773 5810 5836 5838 5852  
5863 5890 5927 5937 5950 5975 5976 5997 6009 6039 6041 6057 6063 6064 6070  
6072 6117 6155 6161 6169 6180 6221 6245 6246 6254 6260 6263 6272 6277 6297  
6305 6307 6310 6312 6313 6314 6315 6316 6317 6318 6319 6320 6321 6322 6323  
6325 6361 6362 6363 6394 6420 6421 6423 6425 6427 6428 6429 6448 6449 6475  
6486 6489 6528 6533 6538 6564 6577 6582 6594 6597 6654 6663 6676 6688 6710  
6713 6714 6715 6718 6730 6731 6738 6739 6740 6744 6747 6757 6759 6760 6768  
6779 6787 6817 6819 6827 6838 6876 6883 6884 6911 6919 6953 6962 6963 6965  
7006 7045 7087 7091 7101 7114 7135 7155 7156 7157 7158 7159 7163 7164 7173  
7174 7175 7189 7193 7196 7198 7200 7201 7204 7208 7209 7210 7223 7224 7230  
7232 7235 7246 7248 7249 7317 7325 7337 7340 7371 7381 7389 7405 7419 7425  
7431 7434 7435 7459 7461 7476 7516 7519 7522 7531 7551 7552 7556 7592 7601  
7602 7638 7639 7645 7647 7648 7649 7651 7652 7654 7655 7656 7672 7673 7675  
7677 7679 7681 7682 7684 7705 7715 7723 7820 7829 7834 7835 7852 7853 7879  
7904 7927 7932 7948 7958 7971 7995 7996 8016 8034 8043 8055 8073 8082 8088  
8097 8109 8111 8116 8130 8131

being By-laws which amended the  
Zoning and Development By-law  
by rezoning areas to CD-1

THE COUNCIL OF THE CITY OF VANCOUVER, in open meeting  
assembled, enacts as follows:

1. By-law No. 3907 is amended in Section 2 by deleting the period from the end  
of clause (b) and substituting it with a semi-colon and by adding the following clause:

"(c) where exterior walls greater than 152 mm in thickness have been  
recommended by a Building Envelope Professional as defined in the Building  
By-law, the area of the walls exceeding 152 mm, but to a maximum exclusion  
of 152 mm thickness, except that this clause shall not apply to walls in  
existence prior to March 14, 2000."

2. By-law No. 4412 is amended in Section 2 by deleting the period from the end of clause (b) and substituting it with a semi-colon and by adding the following clause:

"(c) where exterior walls greater than 152 mm in thickness have been recommended by a Building Envelope Professional as defined in the Building By-law, the area of the walls exceeding 152 mm, but to a maximum exclusion of 152 mm thickness, shall be excluded in the computation of floor space ratio, except that this clause shall not apply to walls in existence prior to March 14, 2000."

3. By-law No. 5376 is amended in Section 2 by deleting the period from the end of subclause (iii) and substituting it with a semi-colon and by adding the following subclause:

"(iv) where exterior walls greater than 152 mm in thickness have been recommended by a Building Envelope Professional as defined in the Building By-law, the area of the walls exceeding 152 mm, but to a maximum exclusion of 152 mm thickness, except that this subclause shall not apply to walls in existence prior to March 14, 2000."

4. By-laws No. 4825 and 6325 are each amended in Section 3 by deleting the period from the end of subclause (ii) and substituting it with a semi-colon and by adding the following subclause:

"(iii) where exterior walls greater than 152 mm in thickness have been recommended by a Building Envelope Professional as defined in the Building By-law, the area of the walls exceeding 152 mm, but to a maximum exclusion of 152 mm thickness, shall be excluded in the computation of floor space ratio, except that this subclause shall not apply to walls in existence prior to March 14, 2000."

5. By-law No. 5343 is amended in Section 3 by deleting the period from the end of clause (iii) and substituting it with a semi-colon and by adding the following clause:

"(iv) where exterior walls greater than 152 mm in thickness have been recommended by a Building Envelope Professional as defined in the Building By-law, the area of the walls exceeding 152 mm, but to a maximum exclusion of 152 mm thickness, except that this clause shall not apply to walls in existence prior to March 14, 2000"

6. By-laws No. 4775, 4829, 5222, 5224, 5773 and 6039 are each amended in Section 3 by deleting the period from the end of clause (b) and substituting it with a semi-colon and by adding the following clause:

"(c) where exterior walls greater than 152 mm in thickness have been recommended by a Building Envelope Professional as defined in the

Building By-law, the area of the walls exceeding 152 mm, but to a maximum exclusion of 152 mm thickness, shall be excluded in the computation of floor space ratio, except that this clause shall not apply to walls in existence prior to March 14, 2000."

7. By-laws No. 4085, 5411, and 5416 are each amended in Section 3 by deleting the period from the end of clause (c) and substituting it with a semi-colon and by adding the following clause:

"(d) where exterior walls greater than 152 mm in thickness have been recommended by a Building Envelope Professional as defined in the Building By-law, the area of the walls exceeding 152 mm, but to a maximum exclusion of 152 mm thickness, except that this clause shall not apply to walls in existence prior to March 14, 2000."

8. By-law No. 5407 is amended in Section 3 by deleting the period from the end of clause (d) and substituting it with a semi-colon and by adding the following clause:

"(e) where exterior walls greater than 152 mm in thickness have been recommended by a Building Envelope Professional as defined in the Building By-law, the area of the walls exceeding 152 mm, but to a maximum exclusion of 152 mm thickness, except that this clause shall not apply to walls in existence prior to March 14, 2000."

9. The By-laws listed below are each amended in Section 3 by adding the following section:

"3.1 Where exterior walls greater than 152 mm in thickness have been recommended by a Building Envelope Professional as defined in the Building By-law, the area of the walls exceeding 152 mm, but to a maximum exclusion of 152 mm thickness, shall be excluded in the computation of floor space ratio, except that this section shall not apply to walls in existence prior to March 14, 2000."

3568 3712 3885 4271 4358 4634 4674 4861 4900 4918 4926 4928  
4930 4940 4958 4999 5009 5011 5014 5028 5060 5145 5179 5184  
5229 5418 5477 5836 5838 5863 5937 5950 5975 5976 4954 6041  
6064 6072 6117 6155 6161 6180 6245 6246 6260 6263 6277 6297  
6305 6307 6394 6420 6425 6427 6428 6429 6448 6449 6489 6538  
6577 6594 6564 6654 6663 6759 6760 6779 6876 6911

10. By-laws No. 6314 and 6582 are each amended in Section 3.1 by deleting the period from the end of clause (ii) and substituting it with a semi-colon and by adding the following clause:

"(iii) where exterior walls greater than 152 mm in thickness have been recommended by a Building Envelope Professional as defined in the Building By-law, the area of the walls exceeding 152 mm, but to a maximum exclusion of 152 mm thickness, except that this clause shall not apply to walls in existence prior to March 14, 2000."

11. By-law No. 6272 is amended in Section 3.1 by deleting the word "and" from the end of subclause (c)(i), by deleting the period from the end of subclause (c)(ii) and substituting it with a semi-colon and by adding the following subclause:

"(iii) where exterior walls greater than 152 mm in thickness have been recommended by a Building Envelope Professional as defined in the Building By-law, the area of the walls exceeding 152 mm, but to a maximum exclusion of 152 mm thickness, except that this clause shall not apply to walls in existence prior to March 14, 2000."

12. By-law No. 4580 is amended in Section 3.2 by deleting the period at the end of the section and substituting it with a semi-colon, by relettering the existing text as clause (a) and by adding the following clause:

"(b) where exterior walls greater than 152 mm in thickness have been recommended by a Building Envelope Professional as defined in the Building By-law, the area of the walls exceeding 152 mm, but to a maximum exclusion of 152 mm thickness, shall be excluded in the computation of floor space ratio, except that this clause shall not apply to walls in existence prior to March 14, 2000."

13. By-law No. 6884 is amended in Section 3.1 by deleting the word "and" from the end of clause (a), by deleting the period from the end of clause (b) and substituting it with a semi-colon and by adding the following clause:

"(c) where exterior walls greater than 152 mm in thickness have been recommended by a Building Envelope Professional as defined in the Building By-law, the area of the walls exceeding 152 mm, but to a maximum exclusion of 152 mm thickness, except that this clause shall not apply to walls in existence prior to March 14, 2000."

14. By-law No. 5683 is amended in Section 3.2 by deleting the period at the end of this section and substituting it with a semi-colon and by adding the following clause:

"(b) where exterior walls greater than 152 mm in thickness have been recommended by a Building Envelope Professional as defined in the Building By-law, the area of the walls exceeding 152 mm, but to a maximum exclusion of 152 mm thickness, shall be excluded in the computation of floor



space ratio, except that this clause shall not apply to walls in existence prior to March 14, 2000."

15. By-law No. 8088 is amended in Section 3.2 by adding the following clause:

"(d) where exterior walls greater than 152 mm in thickness have been recommended by a Building Envelope Professional as defined in the Building By-law, the area of the walls exceeding 152 mm, but to a maximum exclusion of 152 mm thickness, except that this clause shall not apply to walls in existence prior to March 14, 2000."

16. By-law No. 6009 is amended in Section 3.2 by deleting the period at the end of subclause (e)(vii) and substituting it with a semi-colon and by adding the following clause:

"(f) where exterior walls greater than 152 mm in thickness have been recommended by a Building Envelope Professional as defined in the Building By-law, the area of the walls exceeding 152 mm, but to a maximum exclusion of 152 mm thickness, except that this clause shall not apply to walls in existence prior to March 14, 2000."

17. By-law No. 4677 is amended in Section 3.2 by deleting the period at the end of clause (f) and substituting it with a semi-colon and by adding the following clause:

"(g) where exterior walls greater than 152 mm in thickness have been recommended by a Building Envelope Professional as defined in the Building By-law, the area of the walls exceeding 152 mm, but to a maximum exclusion of 152 mm thickness, except that this clause shall not apply to walls in existence prior to March 14, 2000."

18. The By-laws listed below are each amended in Section 3 by adding the following section:

"3.3 Where exterior walls greater than 152 mm in thickness have been recommended by a Building Envelope Professional as defined in the Building By-law, the area of the walls exceeding 152 mm, but to a maximum exclusion of 152 mm thickness, shall be excluded in the computation of floor space ratio, except that this section shall not apply to walls in existence prior to March 14, 2000."

4238 4860 5579 5717 5810 5852 5890 6057 6070 6310 6312 6313  
6316 6320 6361 6363 6423 6528 6714 6715

19. By-law No. 7684 is amended in Section 3.3 by deleting the period from the end of clause (a) and substituting it with a semi-colon and by adding the following clause:

"(b) where exterior walls greater than 152 mm in thickness have been recommended by a Building Envelope Professional as defined in the Building By-law, the area of the walls exceeding 152 mm, but to a maximum exclusion of 152 mm thickness, except that this clause shall not apply to walls in existence prior to March 14, 2000."

20. The By-laws listed below are each amended in Section 3.3 by deleting the and from clause (a) and by deleting the period from the end of clause (b) and substituting it with a semi-colon and by adding the following clause:

"(c) where exterior walls greater than 152 mm in thickness have been recommended by a Building Envelope Professional as defined in the Building By-law, the area of the walls exceeding 152 mm, but to a maximum exclusion of 152 mm thickness, except that this clause shall not apply to walls in existence prior to March 14, 2000."

7705 7459 7435 7434 7419 7389 6718

21. The By-laws listed below are each amended in Section 3.3 by deleting the period from the end of clause (c) and substituting it with a semi-colon and by adding the following clause:

"(d) where exterior walls greater than 152 mm in thickness have been recommended by a Building Envelope Professional as defined in the Building By-law, the area of the walls exceeding 152 mm, but to a maximum exclusion of 152 mm thickness, except that this clause shall not apply to walls in existence prior to March 14, 2000."

5458 5548 5597 6962 7045 7682

22. The By-laws listed below are each amended in Section 3.3 by deleting the period from the end of clause (d) and substituting it with a semi-colon and by adding the following clause:

"(e) where exterior walls greater than 152 mm in thickness have been recommended by a Building Envelope Professional as defined in the Building By-law, the area of the walls exceeding 152 mm, but to a maximum exclusion of 152 mm thickness, except that this clause shall not apply to walls in existence prior to March 14, 2000."

3897 3983 5510 7144 7208 7476 7516 7820 7927 7996

23. The By-laws listed below are each amended in Section 3.3 by deleting the period from the end of clause (e) and substituting it with a semi-colon and by adding the following clause:

" (f) where exterior walls greater than 152 mm in thickness have been recommended by a Building Envelope Professional as defined in the Building By-law, the area of the walls exceeding 152 mm, but to a maximum exclusion of 152 mm thickness, except that this clause shall not apply to walls in existence prior to March 14, 2000."

5091 6486 6676 6688 6713 6730 6787 6817 7159 7337 7531 7552  
7556 7645 7652 7715 7835 7971 8111

24. The By-laws listed below are each amended in Section 3.3 by deleting the period from the end of clause (f) and substituting it with a semi-colon and by adding the following clause:

"(g) where exterior walls greater than 152 mm in thickness have been recommended by a Building Envelope Professional as defined in the Building By-law, the area of the walls exceeding 152 mm, but to a maximum exclusion of 152 mm thickness, except that this clause shall not apply to walls in existence prior to March 14, 2000."

4391 4049 4397 4597 6421 6710 6731 6738 6739 6740 6768  
6827 6838 6919 6953 6963 6965 7006 7091 7092 7101 7135  
7155 7157 7158 7163 7166 7175 7189 7193 7196 7198 7210  
7223 7224 7230 7325 7340 7381 7519 7551 7602 7638 7639  
7647 7651 7655 7723 7932 7948 8082

25. The By-laws listed below are each amended in Section 3.3 by deleting the period from the end of clause (g) and substituting it with a semi-colon and by adding the following clause:

"(h) where exterior walls greater than 152 mm in thickness have been recommended by a Building Envelope Professional as defined in the Building By-law, the area of the walls exceeding 152 mm, but to a maximum exclusion of 152 mm thickness, except that this clause shall not apply to walls in existence prior to March 14, 2000."

3869 7173 7522 7601 7656 7672 7834 7852 7853 7904 7958

26. By-laws No. 4559, 7209, 7425 and 7431 are each amended in Section 3.3 by deleting the period from the end of clause (h) and substituting it with a semi-colon and by adding the following clause:

"(i) where exterior walls greater than 152 mm in thickness have been recommended by a Building Envelope Professional as defined in the Building By-law, the area of the walls exceeding 152 mm, but to a maximum exclusion of 152 mm thickness, except that this clause shall not apply to walls in existence prior to March 14, 2000."

27. By-laws No. 5997 and 7829 are each amended in Section 3.3 by deleting the period from the end of clause (i) and substituting it with a semi-colon and by adding the following clause:

"(j) where exterior walls greater than 152 mm in thickness have been recommended by a Building Envelope Professional as defined in the Building By-law, the area of the walls exceeding 152 mm, but to a maximum exclusion of 152 mm thickness, except that this clause shall not apply to walls in existence prior to March 14, 2000."

28. The By-laws listed below are each amended in Section 3 by adding the following section:

"3.4 Where exterior walls greater than 152 mm in thickness have been recommended by a Building Envelope Professional as defined in the Building By-law, the area of the walls exceeding 152 mm, but to a maximum exclusion of 152 mm thickness, shall be excluded in the computation of floor space ratio, except that this section shall not apply to walls in existence prior to March 14, 2000."

5762 5927 6315 6317 6318 6319 6321 6323 6362

29. By-law No. 7980 is amended

(a) in Section 3.4 by deleting the period from the end of clause (d) and substituting it with a semi-colon and by adding the following clause:

"(e) where exterior walls greater than 152 mm in thickness have been recommended by a Building Envelope Professional as defined in the Building By-law, the area of the walls exceeding 152 mm, but to a maximum exclusion of 152 mm thickness, except that this clause shall not apply to walls in existence prior to March 14, 2000.", and

(b) in Section 3.7 by deleting the period from the end of clause (f) and substituting it with a semi-colon and by adding the following clause:

"(g) where exterior walls greater than 152 mm in thickness have been recommended by a Building Envelope Professional as defined in the Building By-law, the area of the walls exceeding 152 mm, but to a maximum exclusion of 152 mm thickness, except that this clause shall not apply to walls in existence prior to March 14, 2000."

30. By-laws No. 7087 and 7174 are each amended in Section 3.4 by deleting the period from the end of clause (f) and substituting it with a semi-colon and by adding the following clause:

"(g) where exterior walls greater than 152 mm in thickness have been recommended by a Building Envelope Professional as defined in the Building By-law, the area of the walls exceeding 152 mm, but to a maximum exclusion of 152 mm thickness, except that this clause shall not apply to walls in existence prior to March 14, 2000."

31. By-law No. 7246 is amended in Section 3.4 by deleting the period from the end of clause (h) and substituting it with a semi-colon and by adding the following clause:

"(i) where exterior walls greater than 152 mm in thickness have been recommended by a Building Envelope Professional as defined in the Building By-law, the area of the walls exceeding 152 mm, but to a maximum exclusion of 152 mm thickness, except that this clause shall not apply to walls in existence prior to March 14, 2000."

32. By-laws No. 8034, 8043 and 8116 are each amended in Section 3.4 by deleting the period from the end of clause (f) and substituting it with a semi-colon and by adding the following clause:

"(g) where exterior walls greater than 152 mm in thickness have been recommended by a Building Envelope Professional as defined in the Building By-law, the area of the walls exceeding 152 mm, but to a maximum exclusion of 152 mm thickness, except that this clause shall not apply to walls in existence prior to March 14, 2000."

33. By-laws No. 6322 and 6597 are each amended in Section 3 by adding the following section:

"3.5 Where exterior walls greater than 152 mm in thickness have been recommended by a Building Envelope Professional as defined in the Building By-law, the area of the walls exceeding 152 mm, but to a maximum exclusion of 152 mm thickness, shall be excluded in the computation of floor space ratio, except that this section shall not apply to walls in existence prior to March 14, 2000."

34. By-law No. 8016 is amended in Section 3.5 by deleting the period from the end of clause (g) and substituting it with a semi-colon and by adding the following clause:

"(h) where exterior walls greater than 152 mm in thickness have been recommended by a Building Envelope Professional as defined in the Building By-law, the area of the walls exceeding 152 mm, but to a maximum exclusion of 152 mm thickness, except that this clause shall not apply to walls in existence prior to March 14, 2000."

35. By-law No. 8055 is amended in Section 3.5 by deleting the period from the end of clause (h) and substituting it with a semi-colon and by adding the following clause:

"(i) where exterior walls greater than 152 mm in thickness have been recommended by a Building Envelope Professional as defined in the Building By-law, the area of the walls exceeding 152 mm, but to a maximum exclusion of 152 mm thickness, except that this clause shall not apply to walls in existence prior to March 14, 2000."

36. By-law No. 8130 is amended in Section 3.6 by deleting the period from the end of clause (e) and substituting it with a semi-colon and by adding the following clause:

"(f) where exterior walls greater than 152 mm in thickness have been recommended by a Building Envelope Professional as defined in the Building By-law, the area of the walls exceeding 152 mm, but to a maximum exclusion of 152 mm thickness, except that this clause shall not apply to walls in existence prior to March 14, 2000."

37. By-law No. 7648 is amended in Section 3.6 by deleting the period from the end of clause (f) and substituting it with a semi-colon and by adding the following clause:

"(g) where exterior walls greater than 152 mm in thickness have been recommended by a Building Envelope Professional as defined in the Building By-law, the area of the walls exceeding 152 mm, but to a maximum exclusion of 152 mm thickness, except that this clause shall not apply to walls in existence prior to March 14, 2000."

38. By-laws No. 6063 and 6221 are each amended in Section 3 by adding the following section:

"4.1 Where exterior walls greater than 152 mm in thickness have been recommended by a Building Envelope Professional as defined in the Building By-law, the area of the walls exceeding 152 mm, but to a maximum exclusion of 152 mm thickness, shall be excluded in the computation of floor space ratio, except that this section shall not apply to walls in existence prior to March 14, 2000."

39. By-law No. 5555 is amended in Section 4 by deleting the period from the end of clause (b) and substituting it with a semi-colon and by adding the following clause:

"(c) where exterior walls greater than 152 mm in thickness have been recommended by a Building Envelope Professional as defined in the Building By-law, the area of the walls exceeding 152 mm, but to a maximum exclusion of 152 mm thickness, shall be excluded in the computation of floor space ratio, except that this clause shall not apply to walls in existence prior to March 14, 2000."

40. By-law No. 5705 is amended in Section 4 by adding the following section:

"4.3 Where exterior walls greater than 152 mm in thickness have been recommended by a Building Envelope Professional as defined in the Building By-law, the area of the walls exceeding 152 mm, but to a maximum exclusion of 152 mm thickness, shall be excluded in the computation of floor space ratio, except that this section shall not apply to walls in existence prior to March 14, 2000."

41. By-law No. 7371 is amended in Section 4.3 by deleting the period from the end of clause (a) and substituting it with a semi-colon and by adding the following clause:

"(b) where exterior walls greater than 152 mm in thickness have been recommended by a Building Envelope Professional as defined in the Building By-law, the area of the walls exceeding 152 mm, but to a maximum exclusion of 152 mm thickness, except that this clause shall not apply to walls in existence prior to March 14, 2000."

42. By-law No. 7249 is amended in Section 4.3 by deleting the period from the end of clause (c) and substituting it with a semi-colon and by adding the following clause:

"(d) where exterior walls greater than 152 mm in thickness have been recommended by a Building Envelope Professional as defined in the Building By-law, the area of the walls exceeding 152 mm, but to a maximum exclusion of 152 mm thickness, except that this clause shall not apply to walls in existence prior to March 14, 2000."

43. By-laws No. 5702 and 7673 are each amended in Section 4.3 by deleting the period from the end of clause (d) and substituting it with a semi-colon and by adding the following clause:

"(e) where exterior walls greater than 152 mm in thickness have been recommended by a Building Envelope Professional as defined in the Building By-law, the area of the walls exceeding 152 mm, but to a maximum exclusion of 152 mm thickness, except that this clause shall not apply to walls in existence prior to March 14, 2000."

44. By-laws No. 6819 and 7238 are each amended in Section 4.3 by deleting the period from the end of clause (e) and substituting it with a semi-colon and by adding the following clause:

"(f) where exterior walls greater than 152 mm in thickness have been recommended by a Building Envelope Professional as defined in the Building By-law, the area of the walls exceeding 152 mm, but to a maximum exclusion of 152 mm thickness, except that this clause shall not apply to walls in existence prior to March 14, 2000."

45. The By-laws listed below are each amended in Section 4.3 by deleting the period from the end of clause (f) and substituting it with a semi-colon and by adding the following clause:

"(g) where exterior walls greater than 152 mm in thickness have been recommended by a Building Envelope Professional as defined in the Building By-law, the area of the walls exceeding 152 mm, but to a maximum exclusion of 152 mm thickness, except that this clause shall not apply to walls in existence prior to March 14, 2000."

3632 3706 4131 7649 7995 8073 8097

46. By-law No. 5381 is amended in Section 4.3.3 by adding after the existing text the following:

" - where exterior walls greater than 152 mm in thickness have been recommended by a Building Envelope Professional as defined in the Building By-law, the area of the walls exceeding 152 mm, but to a maximum exclusion of 152 mm thickness, except that this clause shall not apply to walls in existence prior to March 14, 2000."

47. By-law No. 7592 is amended in Section 4.4 by deleting the period from the end of clause (d) and substituting it with a semi-colon and by adding the following clause:

"(e) where exterior walls greater than 152 mm in thickness have been recommended by a Building Envelope Professional as defined in the Building By-law, the area of the walls exceeding 152 mm, but to a maximum exclusion of 152 mm thickness, except that this clause shall not apply to walls in existence prior to March 14, 2000."

48. By-law No. 6883 is amended in Section 4.4 by deleting the period from the end of clause (e) and substituting it with a semi-colon and by adding the following clause:

"(f) where exterior walls greater than 152 mm in thickness have been recommended by a Building Envelope Professional as defined in the Building By-law, the area of the walls exceeding 152 mm, but to a maximum exclusion of 152 mm thickness, except that this clause shall not apply to walls in existence prior to March 14, 2000."

49. By-laws No. 4037 and 7405 are each amended in Section 4.4 by deleting the period from the end of clause (f) and substituting it with a semi-colon and by adding the following clause:

"(g) where exterior walls greater than 152 mm in thickness have been recommended by a Building Envelope Professional as defined in the Building By-law, the area of the walls exceeding 152 mm, but to a maximum



exclusion of 152 mm thickness, except that this clause shall not apply to walls in existence prior to March 14, 2000."

50. By-law No. 7201 is amended in Section 4.5 by deleting the period from the end of clause (c) and substituting it with a semi-colon and by adding the following clause:

"(d) where exterior walls greater than 152 mm in thickness have been recommended by a Building Envelope Professional as defined in the Building By-law, the area of the walls exceeding 152 mm, but to a maximum exclusion of 152 mm thickness, except that this clause shall not apply to walls in existence prior to March 14, 2000."

51. By-law No. 5383 is amended in Section 5 by deleting the period from the end of clause (b) and substituting it with a semi-colon and by adding the following clause:

"(c) where exterior walls greater than 152 mm in thickness have been recommended by a Building Envelope Professional as defined in the Building By-law, the area of the walls exceeding 152 mm, but to a maximum exclusion of 152 mm thickness, except that this clause shall not apply to walls in existence prior to March 14, 2000."

52. By-law No. 6533 is amended in Section 5.2.4 by deleting the period at the end of the existing text and substituting it with a semi-colon and by adding the following:

" - where exterior walls greater than 152 mm in thickness have been recommended by a Building Envelope Professional as defined in the Building By-law, the area of the walls exceeding 152 mm, but to a maximum exclusion of 152 mm thickness, except that this clause shall not apply to walls in existence prior to March 14, 2000."

53. By-law No. 7654 is amended in Section 5.3 by deleting the period from the end of clause (f) and substituting it with a semi-colon and by adding the following clause:

"(g) where exterior walls greater than 152 mm in thickness have been recommended by a Building Envelope Professional as defined in the Building By-law, the area of the walls exceeding 152 mm, but to a maximum exclusion of 152 mm thickness, except that this clause shall not apply to walls in existence prior to March 14, 2000."

54. By-law No. 7677 is amended in Section 5.3 by deleting the period from the end of clause (g) and substituting it with a semi-colon and by adding the following clause:

"(h) where exterior walls greater than 152 mm in thickness have been recommended by a Building Envelope Professional as defined in the Building By-law, the area of the walls exceeding 152 mm, but to a maximum

exclusion of 152 mm thickness, except that this clause shall not apply to walls in existence prior to March 14, 2000."

55. By-laws No. 7675, 7681 and 8109 are each amended in Section 5.3 by deleting the period from the end of clause (h) and substituting it with a semi-colon and by adding the following clause:

"(i) where exterior walls greater than 152 mm in thickness have been recommended by a Building Envelope Professional as defined in the Building By-law, the area of the walls exceeding 152 mm, but to a maximum exclusion of 152 mm thickness, except that this clause shall not apply to walls in existence prior to March 14, 2000."

56. By-laws No. 3865 and 6475 are each amended in Section 5.3.3 by deleting the period from the end of the existing text and substituting it with a semi-colon and by adding the following:

" - where exterior walls greater than 152 mm in thickness have been recommended by a Building Envelope Professional as defined in the Building By-law, the area of the walls exceeding 152 mm, but to a maximum exclusion of 152 mm thickness, except that this clause shall not apply to walls in existence prior to March 14, 2000."

57. By-law No. 7879 is amended in Section 5.4 by deleting the period from the end of clause (f) and substituting it with a semi-colon and by adding the following clause:

"(g) where exterior walls greater than 152 mm in thickness have been recommended by a Building Envelope Professional as defined in the Building By-law, the area of the walls exceeding 152 mm, but to a maximum exclusion of 152 mm thickness, except that this clause shall not apply to walls in existence prior to March 14, 2000."

58. By-law No. 8131 is amended in Section 5.4 by deleting the period from the end of clause (j) and substituting it with a semi-colon and by adding the following clause:

"(k) where exterior walls greater than 152 mm in thickness have been recommended by a Building Envelope Professional as defined in the Building By-law, the area of the walls exceeding 152 mm, but to a maximum exclusion of 152 mm thickness, except that this clause shall not apply to walls in existence prior to March 14, 2000."

59. By-law No. 6169 is amended in Section 6 by adding the following section:

"6.1 Where exterior walls greater than 152 mm in thickness have been recommended by a Building Envelope Professional as defined in the

Building By-law, the area of the walls exceeding 152 mm, but to a maximum exclusion of 152 mm thickness, shall be excluded in the computation of floor space ratio, except that this section shall not apply to walls in existence prior to March 14, 2000."

60. By-law No. 7679 is amended in Section 6.3 by deleting the period from the end of clause (d) and substituting it with a semi-colon and by adding the following clause:

"(e) where exterior walls greater than 152 mm in thickness have been recommended by a Building Envelope Professional as defined in the Building By-law, the area of the walls exceeding 152 mm, but to a maximum exclusion of 152 mm thickness, except that this clause shall not apply to walls in existence prior to March 14, 2000."

61. By-law No. 7317 is amended in Section 6.3 by deleting the period from the end of clause (f) and substituting it with a semi-colon and by adding the following clause:

"(g) where exterior walls greater than 152 mm in thickness have been recommended by a Building Envelope Professional as defined in the Building By-law, the area of the walls exceeding 152 mm, but to a maximum exclusion of 152 mm thickness, except that this clause shall not apply to walls in existence prior to March 14, 2000."

62. By-laws No. 7156, 7200, and 7232 are each amended in Section 6.3 by deleting the period from the end of clause (g) and substituting it with a semi-colon and by adding the following clause:

"(h) where exterior walls greater than 152 mm in thickness have been recommended by a Building Envelope Professional as defined in the Building By-law, the area of the walls exceeding 152 mm, but to a maximum exclusion of 152 mm thickness, except that this clause shall not apply to walls in existence prior to March 14, 2000."

63. By-law No. 7461 is amended in Section 6.3 of Schedule B by deleting the period from the end of clause (h) and substituting it with a semi-colon and by adding the following clause:

"(i) where exterior walls greater than 152 mm in thickness have been recommended by a Building Envelope Professional as defined in the Building By-law, the area of the walls exceeding 152 mm, but to a maximum exclusion of 152 mm thickness, except that this clause shall not apply to walls in existence prior to March 14, 2000."

64. By-law No. 7248 is amended in Section 6.3 by deleting the period from the end of clause (i) and substituting it with a semi-colon and by adding the following clause:

"(j) where exterior walls greater than 152 mm in thickness have been recommended by a Building Envelope Professional as defined in the Building By-law, the area of the walls exceeding 152 mm, but to a maximum exclusion of 152 mm thickness, except that this clause shall not apply to walls in existence prior to March 14, 2000."

65. By-law No. 6744 is amended in Section 6.3 by deleting the period from the end of clause (j) and substituting it with a semi-colon and by adding the following clause:

"(k) where exterior walls greater than 152 mm in thickness have been recommended by a Building Envelope Professional as defined in the Building By-law, the area of the walls exceeding 152 mm, but to a maximum exclusion of 152 mm thickness, except that this clause shall not apply to walls in existence prior to March 14, 2000."

66. By-laws No. 6747 and 7204 are each amended in Section 7.3 of Schedule B, by deleting the period from the end of clause (f) and substituting it with a semi-colon and by adding the following clause:

"(g) where exterior walls greater than 152 mm in thickness have been recommended by a Building Envelope Professional as defined in the Building By-law, the area of the walls exceeding 152 mm, but to a maximum exclusion of 152 mm thickness, except that this clause shall not apply to walls in existence prior to March 14, 2000."

67. By-law No. 6757 is amended in Section 7.3 by deleting the period from the end of clause (g) and substituting it with a semi-colon and by adding the following clause:

"(h) where exterior walls greater than 152 mm in thickness have been recommended by a Building Envelope Professional as defined in the Building By-law, the area of the walls exceeding 152 mm, but to a maximum exclusion of 152 mm thickness, except that this clause shall not apply to walls in existence prior to March 14, 2000."

68. By-law No. 6254 is amended in Section 8 by deleting the period from the end of the second clause (a), which clause ends with the word "computation", and substituting a semi-colon and by inserting the following clause:

"(b) where exterior walls greater than 152 mm in thickness have been recommended by a Building Envelope Professional as defined in the Building By-law, the area of the walls exceeding 152 mm, but to a maximum exclusion of 152 mm thickness, except that this clause shall not apply to walls in existence prior to March 14, 2000;"

69.

This By-law comes into force and takes effect on the date of its passing.

DONE AND PASSED in open Council this 14th day of March , 2000.

(Signed) Philip W. Owen  
Mayor

(Signed) Ulli S. Watkiss  
City Clerk

"I hereby certify that the foregoing is a correct copy of a By-law passed by the Council of the City of Vancouver on the 14th day of March 2000, and numbered 8169.

CITY CLERK"



CITY OF VANCOUVER  
SPECIAL COUNCIL MEETING MINUTES

NOVEMBER 20, 2003

A Special Meeting of the Council of the City of Vancouver was held on Thursday, November 20, 2003, at 7:30 p.m., in the Council Chamber, Third Floor, City Hall, for the purpose of holding a Public Hearing to consider proposed amendments to the Zoning and Development By-law, Official Development Plans, Sign By-law and to designate property as protected heritage property and to enter into a Heritage Revitalization Agreement.

**PRESENT:** Mayor Larry Campbell  
Councillor David Cadman  
Councillor Peter Ladner  
Councillor Raymond Louie  
Councillor Tim Louis  
Councillor Anne Roberts  
Councillor Tim Stevenson  
\*Councillor Sam Sullivan  
Councillor Ellen Woodsworth

**ABSENT:** Councillor Fred Bass (Leave of Absence - Civic Business)  
Councillor Jim Green (Civic Business)

**CITY CLERK'S OFFICE:** Laura Kazakoff, Meeting Coordinator

\*Denotes absence for a portion of the meeting.

**COMMITTEE OF THE WHOLE**

MOVED by Councillor Louis  
SECONDED by Councillor Cadman

THAT this Council resolve itself into Committee of the Whole, Mayor Campbell in the Chair, to consider proposed amendments to the Zoning and Development By-law, Official Development Plans, Sign By-law, to designate property as protected heritage property and to enter into a Heritage Revitalization Agreement.

CARRIED UNANIMOUSLY

**1. Text Amendment: Zoning and Development By-law, CD-1s, and Official Development Plans**

An application by the Director of Current Planning was considered as follows:

Summary: Housekeeping amendments to the Zoning and Development By-law, including CD-1s and Official Development Plans.

The Director of Current Planning recommended approval.

**Staff Comments**

Dave Thomsett, Senior Planner, Rezoning Centre, was present to respond to questions.

#### **Summary of Correspondence**

No correspondence was received since the date the application was referred to Public Hearing.

#### **Speakers**

The Mayor called for speakers for and against the application and none were present.

#### **Council Decision**

MOVED by Councillor Louis

THAT the application by the Director of Current Planning to amend the Zoning & Development By-law, CD-1 By-laws and Official Development Plans generally as set out in Appendices A & B of the Policy Report "Miscellaneous Text Amendments: Zoning and Development By-law, CD-1 By-laws, and Official Development Plans, Zoning and Development Fee By-law and Policies and Guidelines" dated September 23, 2003, be approved.

CARRIED UNANIMOUSLY  
(Councillor Sullivan absent for the vote)

**BY-LAWS**

MOVED by Councillor Cadman  
SECONDED by Councillor Louie

THAT Council, except for those members excused as noted in the agenda, enact the by-laws listed on the agenda for this meeting as numbers 1 to 11 inclusive, and authorize the Mayor and City Clerk to sign and seal the enacted by-laws.

CARRIED UNANIMOUSLY

1. A By-law to amend Zoning and Development By-law No. 3575 (re miscellaneous text amendments) (By-law No. 8758)
2. A By-law to amend By-law Nos. 6180, 6320, and 8587 which amended Zoning and Development By-law No. 3575 by rezoning certain areas to CD-1 (By-law No. 8759)
3. A By-law to amend miscellaneous CD-1 By-laws (re miscellaneous text and residential storage amendments) (By-law 8760)

(Councillors Bass, Green and Sullivan excused from voting)

4. A By-law to amend Zoning and Development By-law No. 3575 (re miscellaneous text and residential storage amendments) (By-law 8761)

(Councillors Bass, Green and Sullivan excused from voting)

5. A By-law to amend Downtown District Official Development Plan By-law No. 4912, Downtown-Eastside/Oppenheimer District Official Development Plan By-law No. 5532, and Southeast Granville Slopes Official Development Plan By-law No. 5752 (By-law 8762)

(Councillors Bass, Green and Sullivan excused from voting)

6. A By-law to amend Solid Waste and Recycling By-law No. 8417 to regulate certain 2004 utility fees and miscellaneous amendments (By-law 8763)

7. A By-law to amend Water Works By-law No. 4848 (2004 Fees and miscellaneous amendments) (By-law 8764)

8. A By-law to authorize the borrowing of certain sums of money from January 8, 2004 to January 7, 2005 pending the collection of real property taxes (By-law No. 8765)

9. A By-law to amend By-law No. 8093, being the Sewer and Watercourse By-law (Establishment of 2004 Sewer Use and Connection Rates) (By-law No. 8766)

10. A By-law to amend License By-law No. 4450 re 2004 marina operator fee increases

(By-law No. 8767)

11. A By-law to amend Impounding By-law No. 3519 (2004 Charges re Towing Service Contract) (By-law 8768)



Special needs residential facilities

BY-LAW NO. 9674

A By-law to amend CD-1 By-law No.'s 3869, 3897, 4271, 4580, 4634, 4671, 5343, 6041, 6070 6072, 6919, 7114, 7193, 7196, 7204, 7210, 7461, 7647, 7679, 7682, 7723, 7852, 8055, 8088, 8111, 8326, 8369, 8457, 8479, 8546, 8880, 9190, 9204, 9454, 9463, 9573, 9594, and 9600

THE COUNCIL OF THE CITY OF VANCOUVER, in public meeting, enacts as follows:

- From each of the CD-1 by-laws listed in Column 1 of Table 1, Council strikes out, from each of the sections listed in Column 2, the words set out in Column 3, and variations of those words, and substitutes the words set out in Column 4:

Table 1

Column 1	Column 2	Column 3	Column 4
3869	2 (b) 5.1 (a)	Special Needs Residential Facility - Community Care - Class B	Community Care Facility - Class B
3897	2 (c) 6 (a)	Special Needs Residential Facility - Community Care - Class B	Community Care Facility - Class B
4271	2 (a)	special needs residential facility (Community Care Facility)	Community Care Facility
4580	3.1	Special Needs Residential Facility: Community Care Facility	Community Care Facility
4634	2 (e)	special needs residential facility (community care facility)	community care facility
	3 Table A	Special Needs Residential Facilities (Community Care Facilities)	Community Care Facilities
	4(c)	special needs residential facility	community care facility
4671	2.2 (a)	Special Needs Residential Facility - Community Care - Class B, and Special Needs Residential Facility - Group Living	Community Care Facility - Class B and Group Residence
5343	2 (a)	Special Needs Residential Facility - Community Care - Class B	Community Care Facility - Class B

6041	2 (c)	Special needs residential facility - community care - Class B	Community care facility - class B
6070	2 (a) (iii)	special - needs residential facility	community care facility or group residence
6072	2 (b)	and Special Needs Residential Facility	Community Care Facility and Group Residence
6919	2 (a)	Special Needs Residential Facility (Community Care Facility)	Community Care Facility
7114	2 (b)	Special Needs Residential Facility - Community Care - Class B	Community Care Facility - Class B
7193	2 (a)	Special Needs Residential Facility - Community Care	Community Care Facility
7196	2 (a)	Special Needs Residential Facility - Community Care - Class B	Community Care Facility - Class B
7204	10 (b) (iv)	Special Needs Residential Facility - Community Care - Class B	Community Care Facility - Class B
7210	2 (a)	Special Needs Residential Facility - Community Care - Class B	Community Care Facility - Class B
7461	6.4 (b)	and special needs residential uses	community care facilities and group residences
7647	2.1 (a)	Special Needs Residential Facilities	of the following: Community Care Facilities or Group Residences
7679	4.1 (d)	and Special Needs Residential Facility	, Community Care Facility and Group Residence
7682	2 (e)	Special Needs Residential Facility - Community Care - Class B	Community Care Facility - Class B
	10 (d)	Special Needs Residential Facility	Community Care Facility
7723	2 (a)	Special Needs Residential Facility - Community Care - Class B	Community Care Facility - Class B
7852	2.1 (b)	Special Needs Residential Facility - Class B	Community Care Facility - Class B
	5	Special Needs Residential Facility	Community Care Facility
8055	2 (a)	Special Needs Residential Facility	Community Care Facility and Group Residence
8088	2 (b)	Special Needs Residential Facility - Community Care - Class B	Community Care Facility - Class B

8111	2 (a) 5.1	Special Needs Residential Facility - Community Care - Class B	Community Care Facility - Class B
8326	2 (b)	Special Needs Residential Facility - Group Living	Group Residence
8369	2 (a)	Special Needs Residential Facility - Community Care - Class B	Community Care Facility - Class B
8457	2 (b)	Special Needs Residential Facility - Community care - Class B	Community Care Facility - Class B
8479	2 (b)	Special Needs Residential Facility - Group Living	Group Residence
8546	2.2 (b)	and Special Needs Residential Facility	Community Care Facility and Group Residence
8880	3	Special Needs Residential Facility	Community Care Facility, Group Residence
9190	3 (c)	and Special Needs Residential Facility	Community Care Facility and Group Residence
9204	3 (b)	and Special Needs Residential Facility	Community Care Facility and Group Residence
9454	3.2 (c)	and Special Needs Residential Facility	Community Care Facility and Group Residence
9463	3.2 (b)	and Special Needs Residential Facility	Community Care Facility and Group Residence
9573	2.2 (b)	and Special Needs Residential Facility	Community Care Facility and Group Residence
9594	3.2 (c)	and Special Needs Residential Facility	Community Care Facility and Group Residence
9600	3.2 (b)	and Special Needs Residential Facility	Community Care Facility and Group Residence

2. A decision by a court that any part of this By-law is illegal, void, or unenforceable severs that part from this By-law, and is not to affect the balance of this By-law.

3. This By-law is to come into force and take effect on the date of its enactment.

ENACTED by Council this 24<sup>th</sup> day of June, 2008

---

Mayor

---

City Clerk

## EXPLANATION

### **A By-law to amend certain CD-1 By-laws re special needs residential facilities**

After the public hearing on June 10, 2008, Council resolved to amend certain CD-1 By-laws to refer to community care facilities rather than special needs residential facilities. The Director of Planning has advised that there are no prior-to conditions, and enactment of the attached by-law will implement Council's resolution.

Director of Legal Services  
June 24, 2008

17. **A By-law to authorize Council entering into a Heritage Revitalization Agreement with the Owner of Heritage Property (re 2978 West 5<sup>th</sup> Avenue) (By-law No. 9687)**  
(Councillors Ball, Cadman and Louie ineligible to vote)
18. **A By-law to designate certain real property as protected heritage property (re 2978 West 5<sup>th</sup> Avenue) (By-law No. 9688)**  
(Councillors Ball, Cadman and Louie ineligible to vote)

MOVED by Councillor Lee  
SECONDED by Councillor Stevenson

THAT Council, except for those members excused as noted in the agenda, enact the by-laws listed on the agenda for this meeting as numbers 3 to 7, 9, 10 and 16, and authorize the Mayor and City Clerk to sign and seal the enacted by-laws.

CARRIED UNANIMOUSLY  
(Councillor Louie absent for the vote)

3. **A By-law to amend Zoning and Development By-law No. 3575 (re special needs residential facilities) (By-law No. 9673)**  
(Councillors Anton, Ball, Capri and Louie ineligible to vote)
4. **A By-law to amend certain CD-1 By-laws re special needs residential facilities (By-law No. 9674)**  
(Councillors Anton, Ball, Capri and Louie ineligible to vote)
5. **A By-law to amend Downtown-Eastside/Oppenheimer Official Development Plan By-law No. 5532 (re special needs residential facilities) (By-law No. 9675)**  
(Councillors Anton, Ball, Capri and Louie ineligible to vote)
6. **A By-law to amend First Shaughnessy Official Development Plan By-law No. 5546 (re special needs residential facilities) (By-law No. 9676)**  
(Councillors Anton, Ball, Capri and Louie ineligible to vote)
7. **A By-law to amend By-law No. 9488 Regarding Areas of Real Property in Certain RM, FM, and CD-1 Zoning Districts (re special needs residential facilities) (By-law No. 9677)**  
(Councillors Anton, Ball, Capri and Louie ineligible to vote)
9. **A By-law to authorize Council entering into a Heritage Revitalization Agreement with the Owner of Heritage Property (re 125 Boundary Road) (By-law No. 9679)**  
(Councillors Anton, Ball, Capri and Louie ineligible to vote)
10. **A By-law to designate certain real property as protected heritage property (re 125 Boundary Road) (By-law No. 9680)**  
(Councillors Anton, Ball, Capri and Louie ineligible to vote)

**ADOPT REPORT OF COMMITTEE OF THE WHOLE**

MOVED by Councillor Lee  
SECONDED by Councillor Deal

THAT the report of the Committee of the Whole be adopted.

CARRIED UNANIMOUSLY

**BY-LAWS**

MOVED by Councillor Anton  
SECONDED by Councillor Stevenson

THAT Council, except for those members excused as noted in the agenda, enact the by-laws listed on the agenda for this meeting as numbers 1, 2, 8, 11, 12, 14, 15, 17 and 18, and authorize the Mayor and City Clerk to sign and seal the enacted by-laws.

CARRIED UNANIMOUSLY  
(Councillor Louie absent for the vote)

1. **A By-law to contract a debt by the issue and sale of debentures in the aggregate principal amount of \$5,722.78 for certain local improvement lane lighting projects, and for imposing an annual special rate on real property specially benefited by such local improvements (By-law No. 9671)**
2. **A By-law to contract a debt by the issue and sale of debentures in the aggregate principal amount of \$554,777.99 for certain local improvement street work projects, including pavement, curbs, trees and bulges, and lane pavement and for imposing an annual special rate on real property specially benefited by such local improvements (By-law No. 9672)**
8. **A By-law to amend Parking By-law No. 6059 (re special needs residential facilities) (By-law No. 9678)**
11. **A By-law to amend Subdivision By-law No. 5208 regarding miscellaneous amendments (By-law No. 9681)**
12. **A By-law to amend Parking By-law No. 6059 (re bicycle spaces) (By-law No. 9682)**
14. **A By-law to amend Sub division By-law No. 5208 (re 5475 Dunbar Street and 3625 and 3641 West 39<sup>th</sup> Avenue) (By-law No. 9684)**
15. **A By-law to amend CD-1 By-law No. 8131 (re Great Northern Way Campus) (By-law No. 9685)**

#### **4. TEXT AMENDMENT: SNRF ZONING AND DEVELOPMENT BY-LAW REVISIONS**

An application by the Director of Planning was considered as follows:

**Summary:** To amend the definitions of Special Need Residential Facilities (SNRF) in the Zoning & Development By-law and make consequential changes to the Zoning & Development By-law and relevant CD-1 By-laws; amend references in the Downtown Eastside/Oppenheimer, Rental Housing Stock and First Shaughnessy Official Development Plan By-laws; and amend the Parking By-law. These are housekeeping amendments to update the definitions.

The Directors of Social Planning, Planning, Development Services, Housing Centre, Legal Services, and General Manager of Engineering Services recommended approval.

Also before Council was a memorandum from Anne Kloppenborg, Social Planning, dated May 20, 2008, which noted an addition to Appendix B of the Policy Report "Special Needs Residential Facilities: Amendments to Definitions and Guidelines" dated April 15, 2008, in order to conform with the draft By-laws prepared by staff.

#### **Staff Opening Comments**

Anne Kloppenborg, Social Planning, reviewed the application, including the memo distributed with the agenda package for the Public Hearing.

#### **Summary of Correspondence**

No correspondence had been received on this application since referral to Public Hearing.

#### **Speakers**

Sister Elizabeth Kelliher and Johnn Olldym spoke in opposition to the application.

#### **Council Decision**

MOVED by Councillor Chow

- A. THAT the application to:
  - i) amend the definitions of Special Needs Residential Facilities in section 2 of the Zoning and Development By-law, and make the necessary consequential changes to the Zoning and Development By-law and to the CD-1 By-laws listed in Appendix A; and
  - ii) amend references to "Special Needs Residential Facilities" in the Downtown Eastside/Oppenheimer, Rental Housing Stock and First Shaughnessy Official Development Plan By-laws,



generally in accordance with Appendix A and B to Policy Report "Special Needs Residential Facilities: Amendments to Definitions and Guidelines", dated April 15, 2008, be approved with the following changes to Appendix B noted in the Memorandum dated May 20, 2008, from Anne Kloppenborg, Social Planning:

In Section 1.1 of the Official Development Plan Regarding Areas of Real Property in Certain RM, FM, and CD-1 Zoning Districts, delete *special needs residential facility* and substitute *community care facility or group residence*; and in Section 2.5, delete the reference to *Special Needs Residential Facility Guidelines* and substitute *Community Care Facility and Group Residence Guidelines*.

- B. THAT Council approve amendments to the Parking By-law, generally in accordance with Appendix C to Policy Report "Special Needs Residential Facilities: Amendments to Definitions and Guidelines", dated April 15, 2008.
- C. THAT if approved at Public Hearing, the by-laws be accompanied at the time of enactment by the Community Care Facilities and Group Residences Guidelines and the Application Procedures for Development Permits for Community Care Facilities and Group Residences, as outlined in Appendix D to Policy Report "Special Needs Residential Facilities: Amendments to Definitions and Guidelines", dated April 15, 2008.

CARRIED UNANIMOUSLY